

Commission:

Mayor:

Francis X. Suarez

D1 Commissioner:

Alex Diaz de la Portilla

D2 Commissioner Vice Chair:

Ken Russell

D3 Commissioner

Joe Carollo

D4 Commissioner

Manolo Reyes

D5 Commissioner

Christine King

City Manager

Arthur Noriega, V

CITY OF MIAMI OFFICE OF CAPITAL IMPROVEMENTS

HECTOR BADIA, INTERIM DIRECTOR

SHENANDOAH MINI-PARK RIGHT-OF-WAY IMPROVEMENTS

PROJECT No. B-203518

Charles M Alfaro
Digitally signed by Charles M Alfaro
Date: 2022.10.31 14:07:41 -04'00'

Resilience and Public Works approval

INDEX OF DRAWINGS:

SHEET NO.	DESCRIPTION
1	KEY SHEET
2	DRAINAGE MAP
3	EXISTING DRAINAGE STRUCTURES
4	TYPICAL SECTIONS
5-7	GENERAL NOTES
8	SUMMARY OF QUANTITIES
9	SUMMARY OF DRAINAGE STRUCTURES
10-11	ROADWAY PLAN
12-13	GRADING PLAN
14-17	ROADWAY PROFILES
18-19	SPECIAL DETAILS
20-30	DRAINAGE STRUCTURES
31-36	DRAINAGE DETAILS
37-52	CROSS SECTIONS
53-54	STORMWATER POLLUTION PREVENTION PLAN
55-59	TRAFFIC CONTROL PLAN
60	VERIFY UTILITY LOCATE
61	SIGNING AND PAVEMENT MARKING QUANTITIES
62-63	SIGNING AND PAVEMENT MARKING PLANS
L1 - L4	LANDSCAPE PLANS

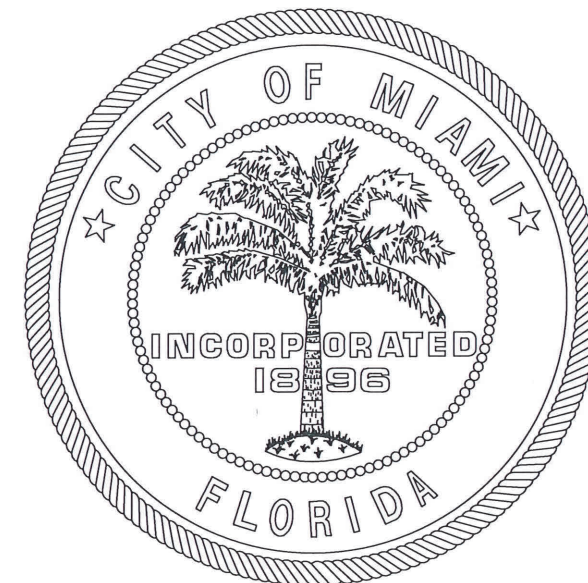
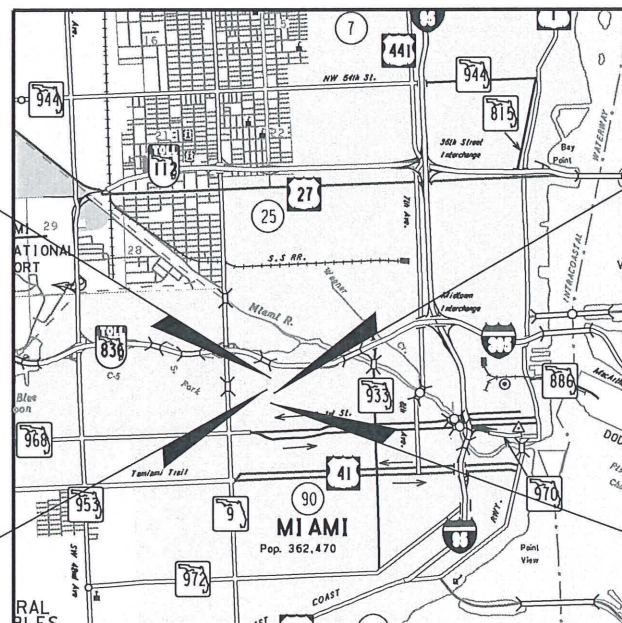

ROADWAY SHOP DRAWINGS TO BE SUBMITTED TO:

SAMUEL E. GONZALEZ, PE
RS&H, INC.
6303 BLUE LAGOON DRIVE, SUITE 325
MIAMI, FL 33126
(305)428-3200

PLANS PREPARED BY:

RS&H, Inc.
6303 BLUE LAGOON DRIVE, SUITE 325
MIAMI, FL 33126
(305)428-3200

ROADWAY PLANS
ENGINEER OF RECORD: SAMUEL E. GONZALEZ, PE

P.E. NO: 49513

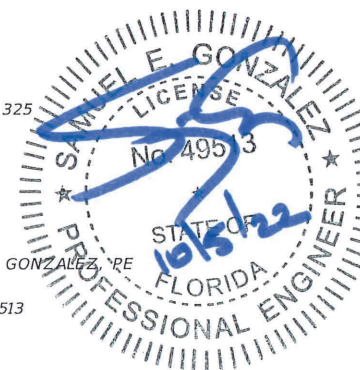

FINAL PLANS
OCTOBER 2022

SHEET NO.
1

REVISIONS:

KEY SHEET REVISIONS	
DATE	DESCRIPTION

ALLWAYS CALL 811 TWO FULL BUSINESS DAYS BEFORE YOU DIG



GOVERNING STANDARD PLANS:

-CITY OF MIAMI ENGINEERING STANDARDS FOR DESIGN AND CONSTRUCTION DATED APRIL 2020.

-FLORIDA DEPARTMENT OF TRANSPORTATION, FY 2020 STANDARD PLANS FOR ROAD AND BRIDGE CONSTRUCTION AND APPLICABLE INTERIM REVISIONS (IRs).

STANDARD PLANS FOR ROAD CONSTRUCTION AND ASSOCIATED IRS ARE AVAILABLE AT THE FOLLOWING WEBSITE: [HTTP://WWW.FDOT.GOV/DESIGN/STANDARDPLANS](http://www.fdot.gov/design/standardplans)

-FLORIDA DEPARTMENT OF TRANSPORTATION, 2020 STANDARD SPECIFICATIONS FOR ROAD AND BRIDGE CONSTRUCTION AT THE FOLLOWING WEBSITE: [HTTP://WWW.FDOT.GOV/PROGRAMMANAGEMENT/IMPLEMENTED/SPECBOOKS](http://www.fdot.gov/programmanagement/implemented/specbooks)

-MANUAL ON UNIFORM TRAFFIC CONTROL DEVICES (MUTCD) 2009 EDITION

CITY OF MIAMI PROJECT MANAGER: L. DIANE WATERS, PE, MS
CITY OF MIAMI CONSTRUCTION MANAGER: MAURICE HARDIE

SECTION 10
TOWNSHIP 54S
RANGE 41E
SHGWT = 1.30 FT-NAVD

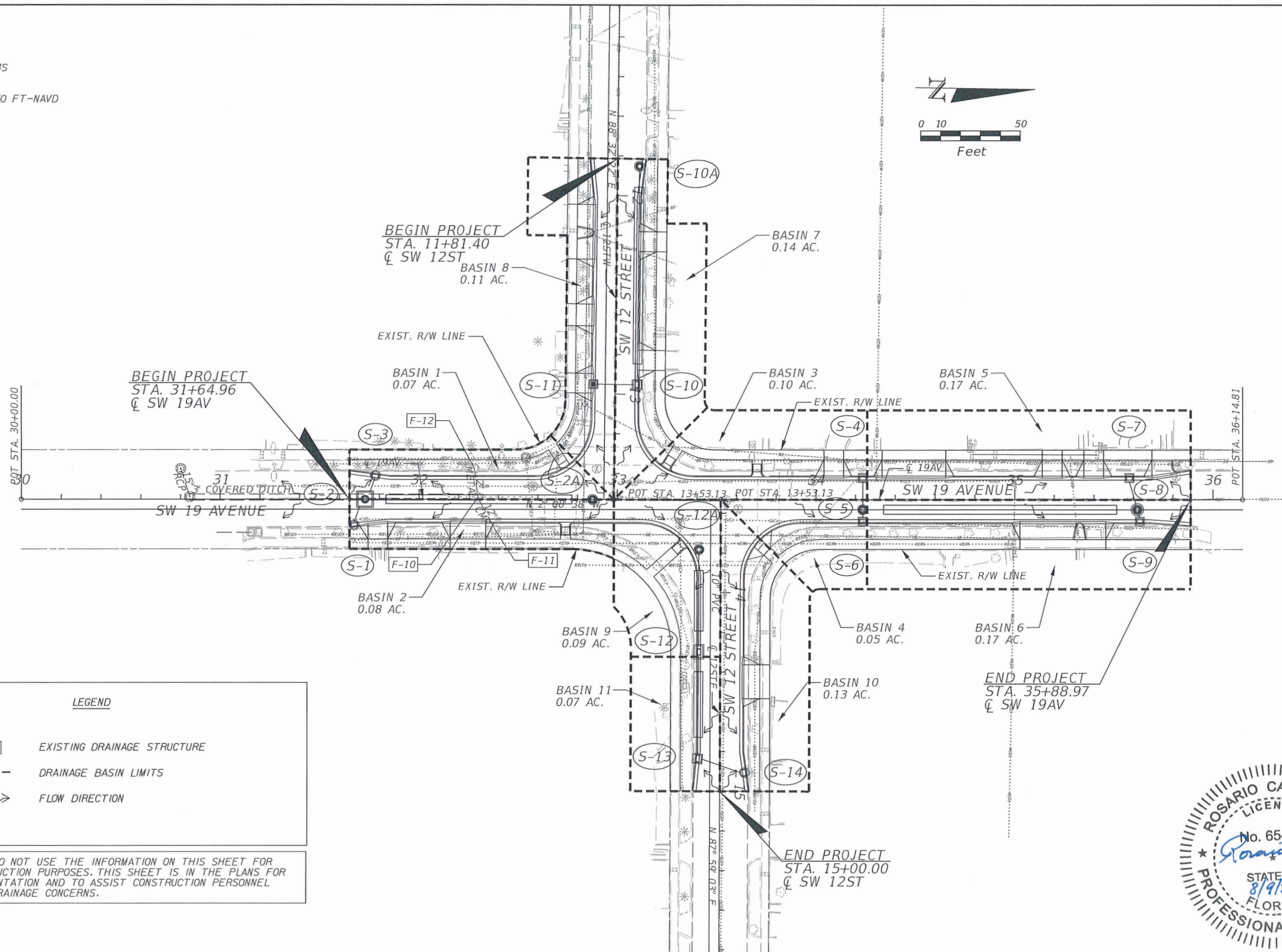
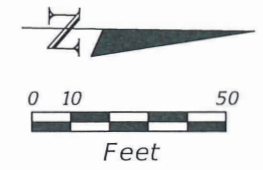

LEGEND

#	EXISTING DRAINAGE STRUCTURE
- - -	DRAINAGE BASIN LIMITS
→	FLOW DIRECTION

NOTE: DO NOT USE THE INFORMATION ON THIS SHEET FOR CONSTRUCTION PURPOSES. THIS SHEET IS IN THE PLANS FOR DOCUMENTATION AND TO ASSIST CONSTRUCTION PERSONNEL WITH DRAINAGE CONCERNS.

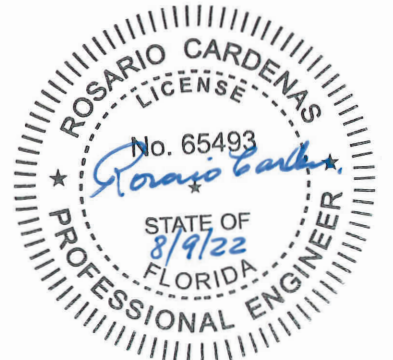

REVISIONS	
DATE	DESCRIPTION

RS&H, Inc.
6303 Blue Lagoon Drive, Suite 325
Miami, Florida 33126

CITY OF MIAMI
CAPITAL IMPROVEMENTS PROGRAM
444 S.W. 2nd AVENUE, 9th FLOOR
MIAMI, FLORIDA 33138
(305) 416-1213 FAX (305) 416-1253

CITY OF MIAMI CAPITAL IMPROVEMENTS PROGRAM	
PROJECT NAME	FINANCIAL PROJECT ID
INTERSECTION OF SW 12TH ST. & SW 19TH AVE.	B-203518

DRAINAGE MAP

SHEET NO.
2

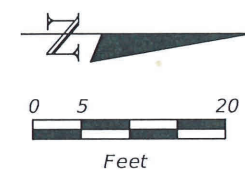
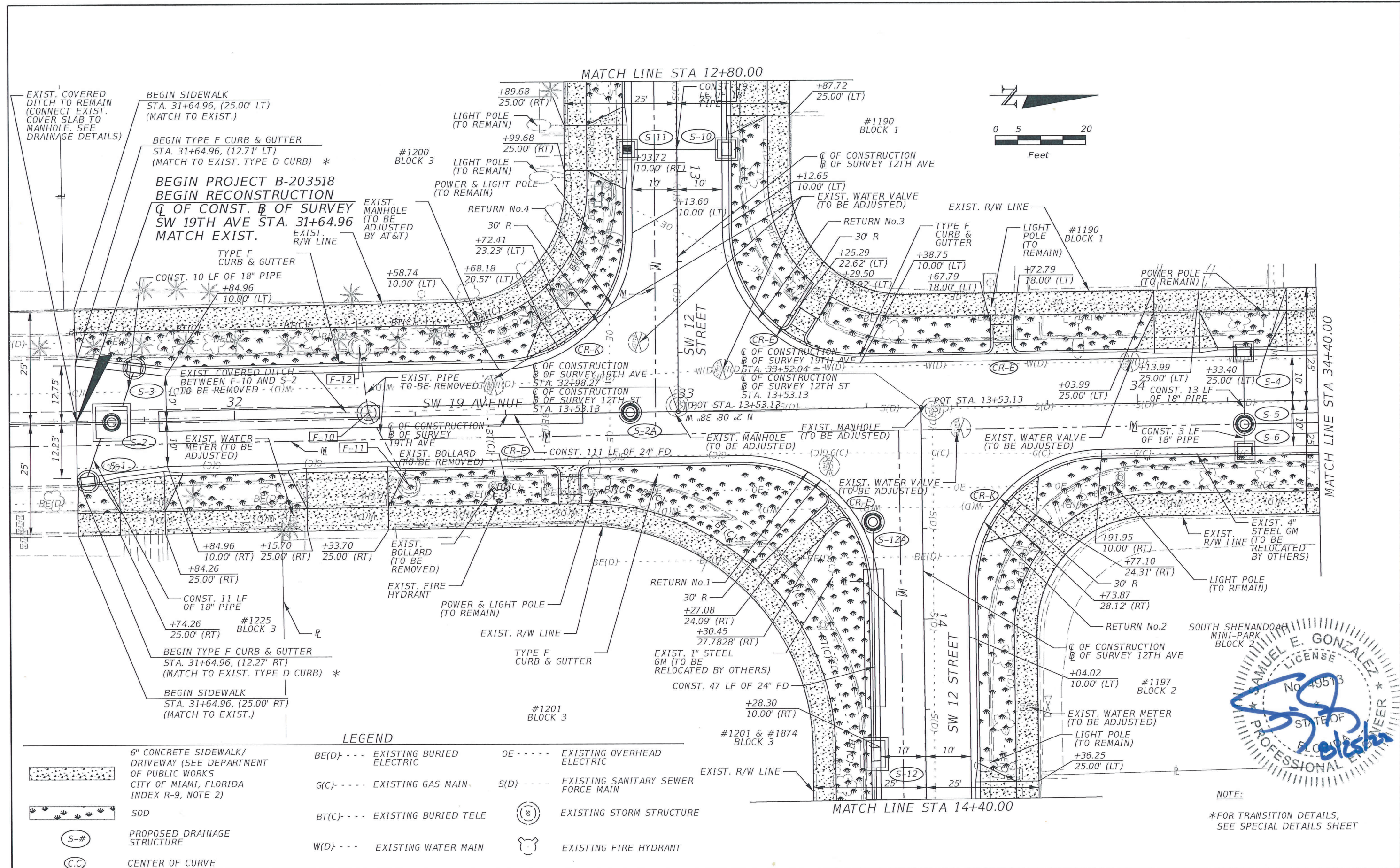

NOTE:
*FOR TRANSITION DETAILS,
SEE SPECIAL DETAILS SHEET

REVISIONS DATE BY DESCRIPTION		RS&H, Inc. 6303 Blue Lagoon Drive, Suite 325 Miami, Florida 33126	CITY OF MIAMI CAPITAL IMPROVEMENTS PROGRAM 444 S.W. 2nd AVENUE, 8th FLOOR MIAMI, FLORIDA 33130 (305) 416-1213 FAX (305) 416-1253	CITY OF MIAMI CAPITAL IMPROVEMENTS PROGRAM		ROADWAY PLAN	SHEET NO. 10
				PROJECT NAME INTERSECTION OF SW 12TH ST. & SW 19TH AVE.	FINANCIAL PROJECT ID B-203518		

MATCHLINE STA. 12+80.00

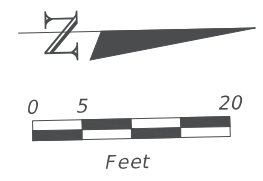

PROPOSED NEW EDGE OF PAVEMENT (TYP)

SW 12TH STREET

10' VISIBILITY TRIANGLE PER THE CITY OF MIAMI (TYP)

SW 19TH AVENUE

SW 19TH AVENUE

25' VISIBILITY TRIANGLE PER THE CITY OF MIAMI (TYP)

MATCHLINE STA. 34+40.00

BEGIN PROJECT
B-203518
STA 31+64.96

LEGEND

	TREE/PALM TO REMAIN		TREE PROTECTION FENCE
	TREE/PALM TO REMOVE		POTENTIAL ROOT PRUNING ROOT BARRIER INSTALLED
	TREE/PALM TO RELOCATE		

MATCHLINE STA. 14+40.00

CURTIS + ROGERS
DESIGN STUDIO INC
Landscape Architecture
7520 S RED ROAD, SUITE M
SOUTH MIAMI, FLORIDA 33143
305.442.1774 | 305.445.9488 FAX
www.curtisrogers.com LC C000241



Aida M. Curtis LA0001330
Jennifer Rogers-Pomville LA6667893
Rafael J. Ferrer LA06657360
Marlene Gabriela Bidou Dallman LA9667246

REVISIONS	
DATE	DESCRIPTION

RS&H, Inc.
6303 Blue Lagoon Drive, Suite 325
Miami, Florida 33126



CITY OF MIAMI
CAPITAL IMPROVEMENTS PROGRAM
444 S.W. 2nd AVENUE, 8th FLOOR
MIAMI, FLORIDA 33130
(305) 416-1213 FAX (305) 416-1253

CITY OF MIAMI CAPITAL IMPROVEMENTS PROGRAM	
PROJECT NAME	FINANCIAL PROJECT ID
INTERSECTION OF SW 12TH ST. & SW 19TH AVE.	B-203518

TREE_DISPOSITION_PLAN

SHEET NO.
L-1

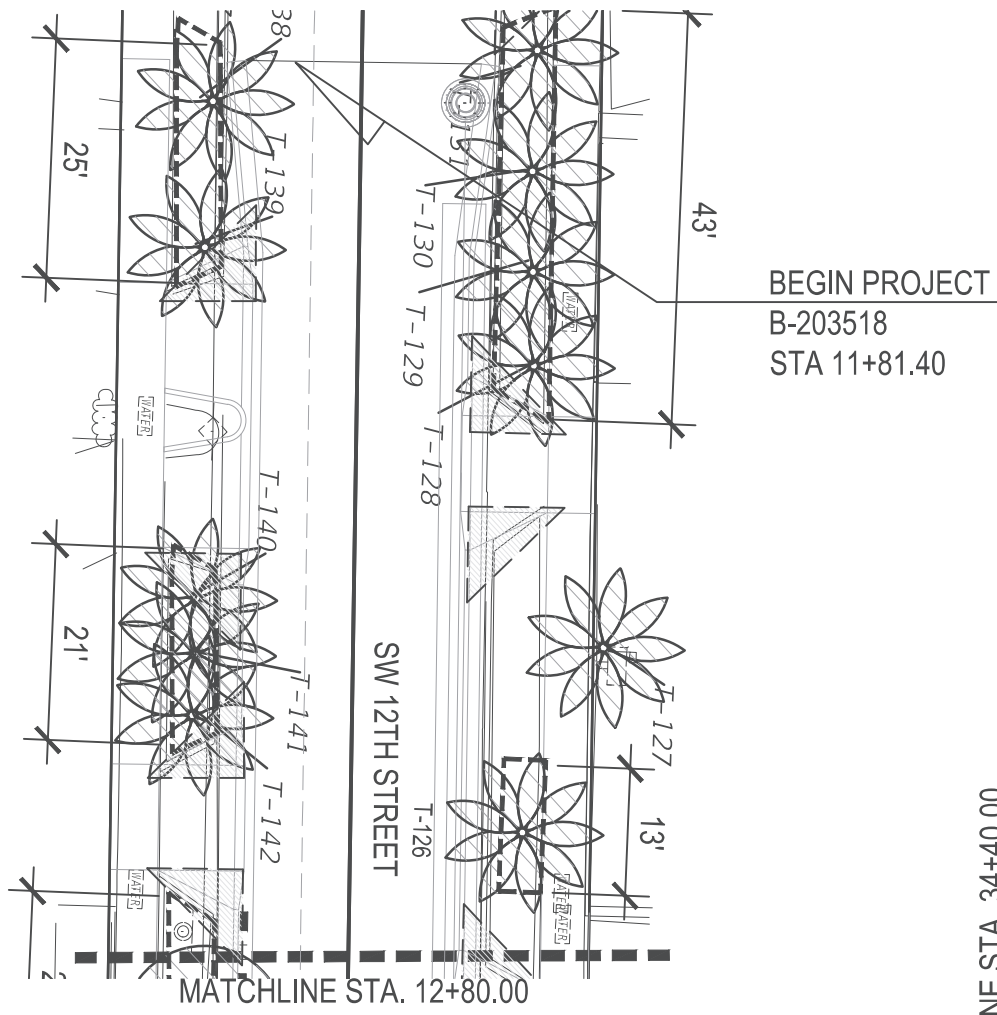

BEGIN PROJECT
B-203518
STA 11+81.40

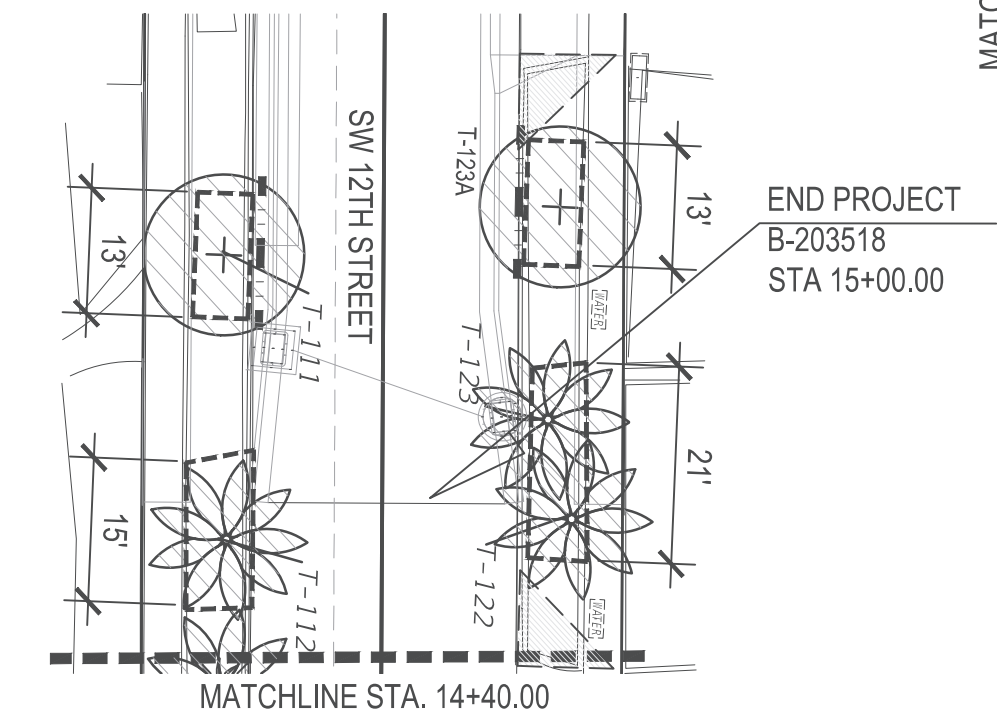
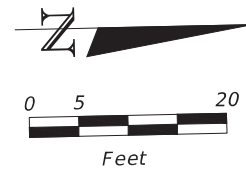

END PROJECT
B-203518
STA 15+00.00

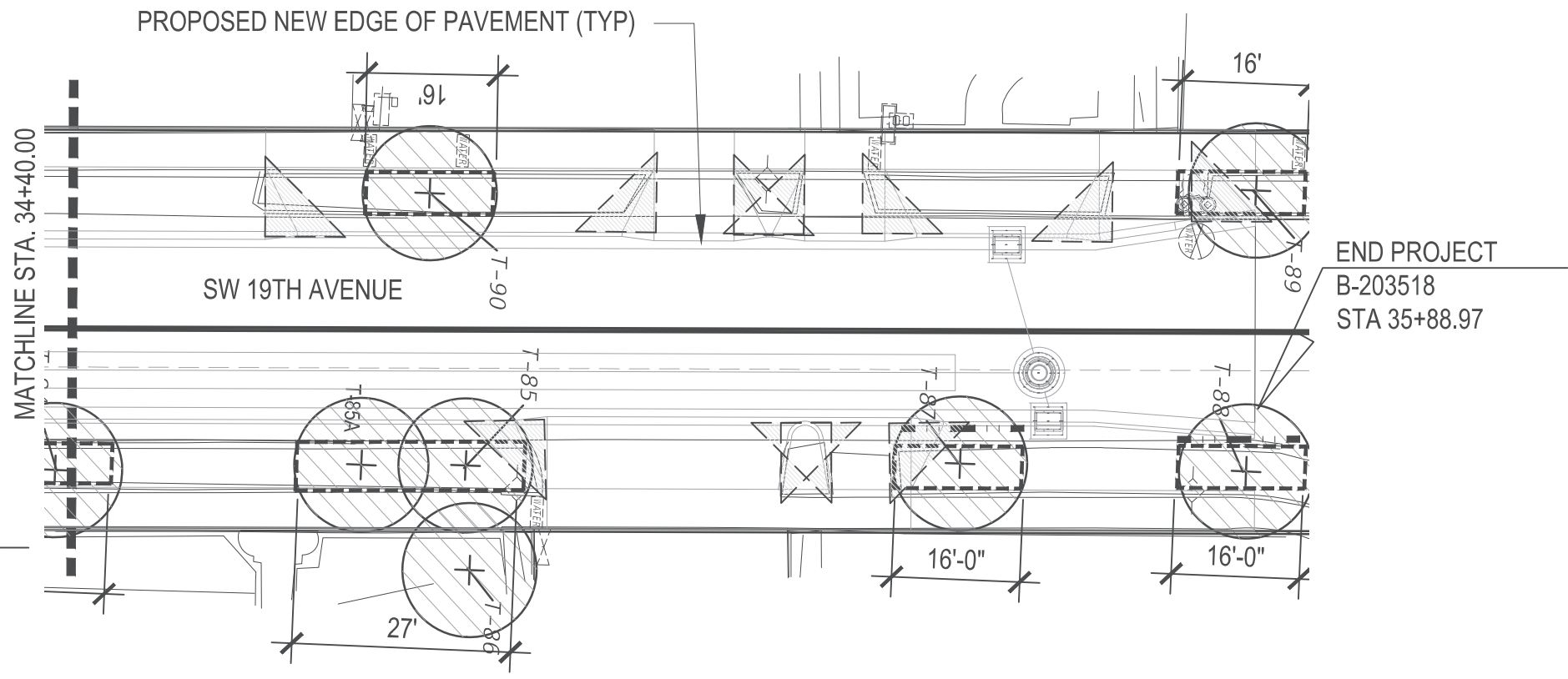

END PROJECT
B-203518
STA 35+88.97

LEGEND

	TREE/PALM TO REMAIN		TREE PROTECTION FENCE
	TREE/PALM TO REMOVE		POTENTIAL ROOT PRUNING ROOT BARRIER INSTALLED
	TREE/PALM TO RELOCATE		

CURTIS + ROGERS
DESIGN STUDIO INC
Landscape Architecture
7520 S RED ROAD, SUITE M
SOUTH MIAMI, FLORIDA 33143
305.442.1774 | 305.445.9488 FAX
www.curtisrogers.com LC: C000241



Aida M. Curtis LA0001330
Jennifer Rogers-Pomante LA6667083
Rafael J. Ferrer LA46607366
Norena Gabriela Sola-Dalman LA6967246

REVISIONS	
DATE	DESCRIPTION

RS&H, Inc.
6303 Blue Lagoon Drive, Suite 325
Miami, Florida 33126



CITY OF MIAMI
CAPITAL IMPROVEMENTS PROGRAM
444 S.W. 2nd AVENUE, 8th FLOOR
MIAMI, FLORIDA 33130
(305) 416-1213 FAX (305) 416-1253

CITY OF MIAMI CAPITAL IMPROVEMENTS PROGRAM	
PROJECT NAME	FINANCIAL PROJECT ID
INTERSECTION OF SW 12TH ST. & SW 19TH AVE.	B-203518

TREE_DISPOSITION_PLAN

SHEET NO.
L-2

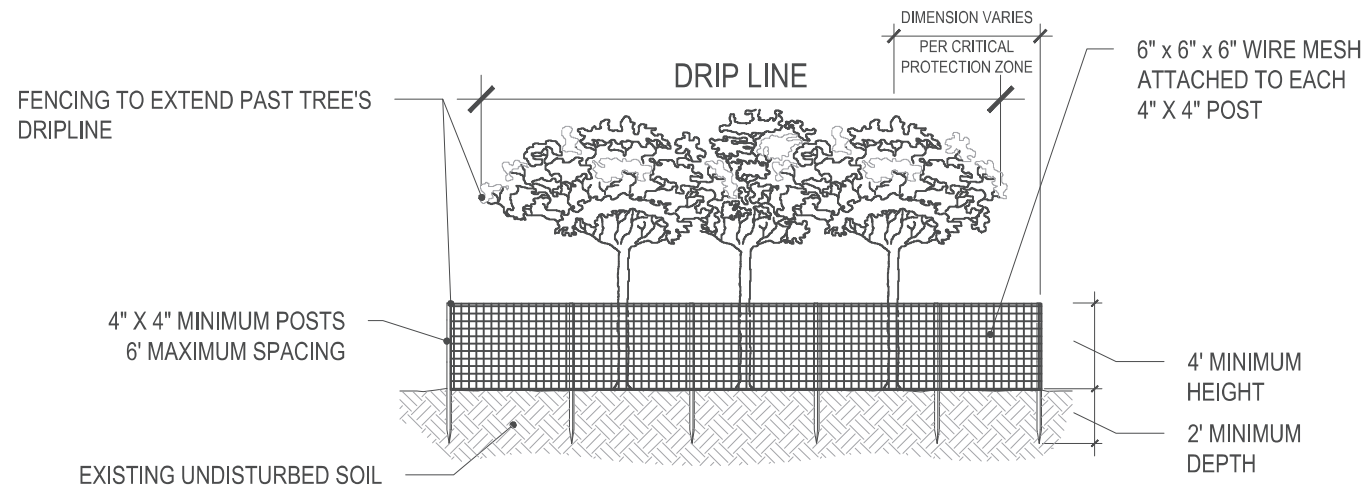

NOTES: TREE PROTECTION ZONE (TPZ): THE AREA SURROUNDING A TREE WITHIN A CIRCLE DESCRIBED BY A RADIUS OF ONE FOOT FOR EACH INCH OF THE TREE TRUNK DIAMETER AT 54" ABOVE FINISHED GRADE. FOR GROUPS OF TREES, PLACE BARRICADES BETWEEN TREES AND CONSTRUCTION ACTIVITY. TREE PROTECTION BARRICADES SHALL BE LOCATED TO PROTECT A MINIMUM OF 75% OF THE CRITICAL PROTECTION ZONE.

1 TREE PROTECTION DETAIL
TREE GROUPINGS

SCALE: NTS

Tree Protection Notes

- 1.0 A Tree Protection Zone (TPZ) shall be established around all trees which are to be retained. The TPZ shall include all such trees in a single cluster, with protective fencing around the perimeter of the cluster.
- 2.0 The TPZ fencing shall be 4 feet high min., with wood posts spaced max. 10 feet o.c., with 2 x 2 wire mesh. Wire mesh shall be securely attached to posts and rails.
- 3.0 The area within the TPZ shall be maintained in its current condition. There shall be no grade changes, bulldozing, scarifying or any other type of soil disturbance within this area. No new utilities shall be installed in this area.
- 4.0 The area within the TPZ shall be kept free of heavy equipment operation. There shall be no movement of heavy equipment within these areas.
- 5.0 The area within the TPZ shall not be used for any type of materials storage or dumping (including wash water).
- 6.0 There shall be no damage, wounding, or other types of physical injury made to the tree trunks, buttress roots, surface roots, limbs, branches, or other exposed parts of the trees. No signage shall be attached to the trees and no work stations set up beneath the trees.
- 7.0 Prior to construction activities, any tree limbs which may interfere with, or are at risk of damage or injury from, construction activities, shall be pruned following the guidelines in the most recent edition of the American National Standards Institute A-300 document. All trees to be retained shall be pruned to clean their crowns, as defined in the ANSI A-300 document (remove dead, diseased, or broken branches).
- 8.0 Any tree roots which are at risk of being cut, damaged or exposed during excavation activities shall be pruned beforehand using appropriate pruning tools (saws, loppers or clippers) and techniques, leaving clean, smooth cuts at a maximum distance allowable from the tree trunks. When digging trenches using trenchers, backhoes or similar equipment, tree roots shall be cut by hand, using appropriate pruning tools, at least 2 to 4 inches further back, toward the tree, from the edge of the trench and behind the equipment-damaged roots. Trenches shall then be backfilled with sand or existing soil.
- 9.0 Heavy equipment shall be routed around all TPZ's. Heavy equipment routes shall have gravel or mulch maintained at a minimum depth of 3 to 4 inches at all times to help disperse weight loads and minimize soil compaction and root damage.

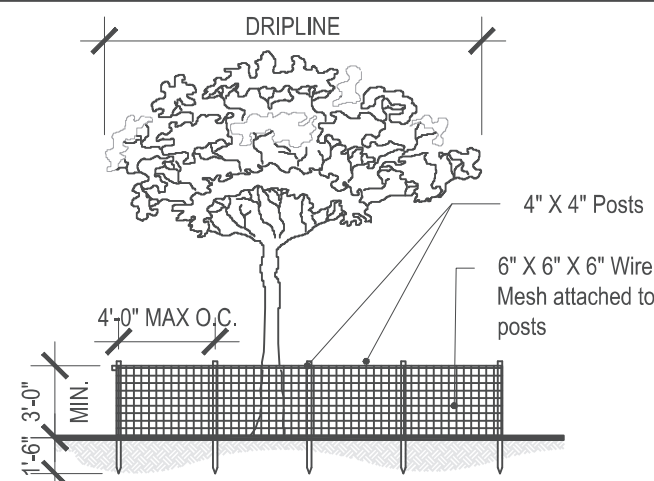

2 STAKING FOR TREE PROTECTION
INDIVIDUAL TREE

SCALE: NTS

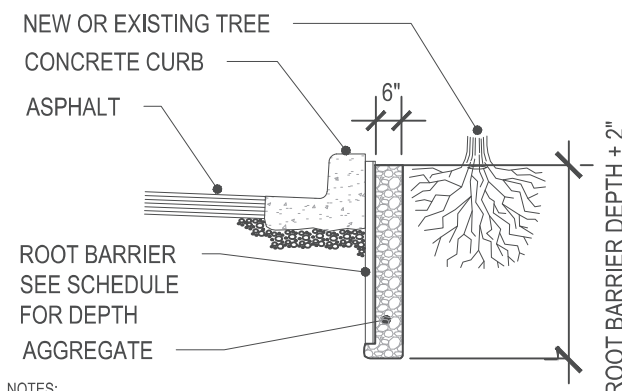

- NOTES:
1. THE RAISED ROOT GUIDING RIBS MUST BE FACING TOWARDS THE TREE ROOTS.
 2. THE TOP OF THE BARRIER PANELS MUST BE SLIGHTLY ABOVE GRADE (NEVER BELOW GRADE).
 3. POSITION BARRIER PANELS VERTICALLY WITH TOP AGAINST THE STRUCTURE TO BE PROTECTED.
 4. SEE LANDSCAPE SITE PLAN TO DETERMINE TREES THAT REQUIRE BARRIER PANEL.

3 ROOT BARRIER ADJACENT TO CURB
SECTION

SCALE: NTS

REVISIONS	
DATE	DESCRIPTION

RS&H, Inc.
6303 Blue Lagoon Drive, Suite 325
Miami, Florida 33126



CITY OF MIAMI
CAPITAL IMPROVEMENTS PROGRAM
444 S.W. 2nd AVENUE, 8th FLOOR
MIAMI, FLORIDA 33130
(305) 416-1213 FAX (305) 416-1253

CITY OF MIAMI CAPITAL IMPROVEMENTS PROGRAM	
PROJECT NAME	FINANCIAL PROJECT ID
INTERSECTION OF SW 12TH ST. & SW 19TH AVE.	B-203518



CURTIS + ROGERS
DESIGN STUDIO INC
Landscape Architecture
7520 S RED ROAD, SUITE M
SOUTH MIAMI, FLORIDA 33143
305.442.1774 | 305.445.9488 FAX
www.curtisrogers.com LC C000241



Aida M. Curtis LA0001330
Jennifer Rogers-Poma LA6667093
Rafael L. Ferner LA6667366
Marlene Gabriela Bofu Dallman LA6667246

**TREE DISPOSITION
DETAILS & NOTES**

SHEET
NO.

L-4