



Mayor  
**Francis Suarez**

Commissioner:

Vice-Chairman - D1 Commissioner

**Wifredo (Willy) Gort**

Chairman - D2 Commissioner

**Ken Russell**

D3 Commissioner

**Joe Carollo**

D4 Commissioner

**Manolo Reyes**

D5 Commissioner

**Keon Hardemon**

City Manager

**Emilio T. Gonzalez**

## INDEX OF SHEETS

SHEET No.	DESCRIPTION
1	KEY SHEET
2	GENERAL NOTES
3	TRAFFIC CALMING DEVICE No. 1 SPEED HUMP PLAN VIEW
4	SPEED HUMP STANDARD DETAILS
5	TRAFFIC CALMING DEVICE No. 2 SPEED TABLE PLAN VIEW
6	SPEED TABLE STANDARD DETAILS
7	TRAFFIC CONTROL PLAN (MOT) NOTES
8-9	SWPPP NOTES AND DETAILS

# CITY OF MIAMI

## OFFICE OF CAPITAL IMPROVEMENTS

STEVEN C. WILLIAMSON, DIRECTOR

### THE ROADS NEIGHBORHOOD

### TRAFFIC CALMING

1. SW 1st Avenue From SW 24th Road to SW 23rd Road
2. SW 1st Avenue From SW 21st Road to SW 20th Road

## PROJECT No. B-193619

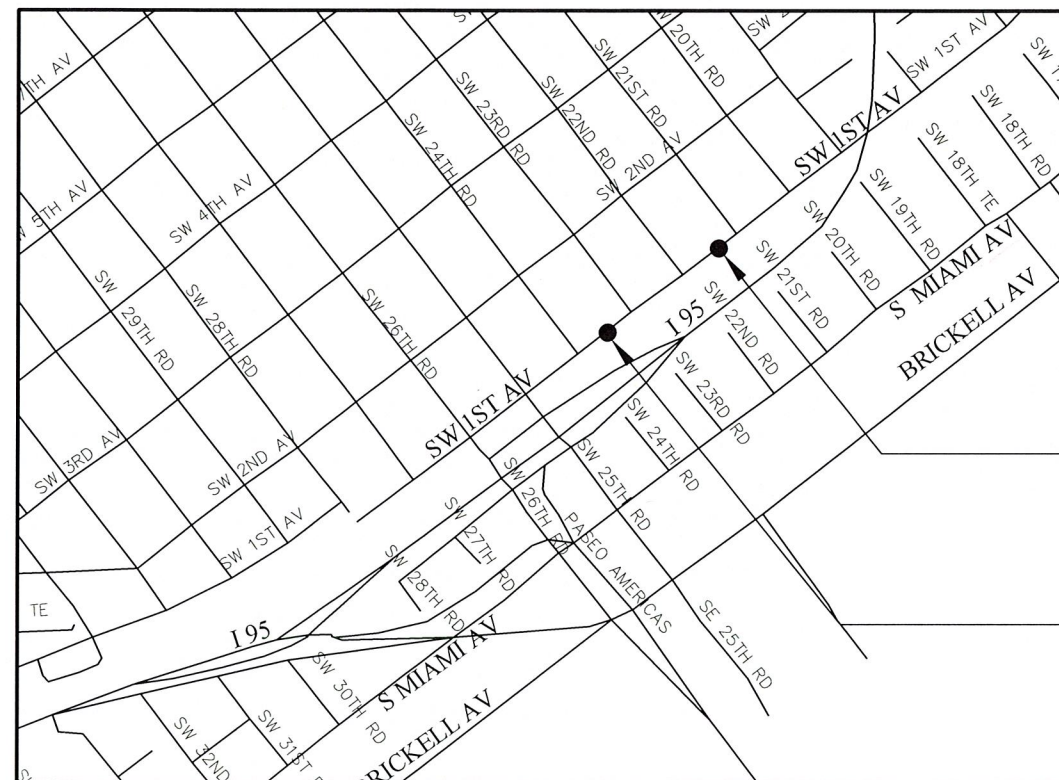

LOCATION MAP  
SCALE: N.T.S.

CITY OF MIAMI PROJECT MANAGER: IVELISSE RODRIGUEZ  
CITY OF MIAMI CONSTRUCTION MANAGER: EDENIA ALUART

#### GOVERNING STANDARDS AND SPECIFICATIONS:

- FLORIDA DEPARTMENT OF TRANSPORTATION, DESIGN STANDARDS DATED 2019, AND STANDARD SPECIFICATIONS FOR ROAD AND BRIDGE CONSTRUCTION DATED 2019, AS AMENDED BY CONTRACT DOCUMENTS.
- CITY OF MIAMI ENGINEERING STANDARDS FOR DESIGN AND CONSTRUCTION DATED DECEMBER 2010.
- THE SCALE OF THESE PLANS MAY HAVE CHANGED DUE TO REPRODUCTION.

**APPROVED**

APPROVAL PERTAINS TO GENERAL DESIGN FEATURES ONLY AND DOES NOT INCLUDE A COMPLETE CHECK OF DIMENSIONS, ELEVATIONS, CONSTRUCTIBILITY OR QUANTITIES. THE ENGINEER OF RECORD IS RESPONSIBLE FOR THE DESIGN, SAFETY AND CONSTRUCTIBILITY OF PLANS AND ASSOCIATED DOCUMENTS.

BY: [Signature]  
DATE: 10/01/2019  
COMMENTS:

TRAFFIC CALMING DEVICE No. 2  
SPEED TABLE

TRAFFIC CALMING DEVICE No. 1  
SPEED HUMP

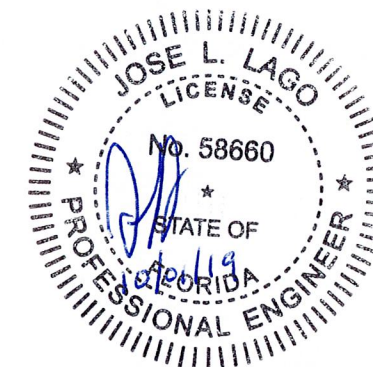

SPACE RESERVED FOR CITY OF MIAMI APPROVAL STAMP

ROADWAY SHOP DRAWINGS TO BE SUBMITTED TO:

JOSE L. LAGO, P.E. CFM  
SR. PROJECT MANAGER

PLANS PREPARED BY:

CITY OF MIAMI  
OFFICE OF CAPITAL IMPROVEMENTS  
444 SW 2ND AVENUE MIAMI, FL 33130  
PHONE: (305)416-1280  
FAX: (305) 416-1253

ROADWAY PLANS  
ENGINEER OF RECORD:

JOSE L. LAGO, P.E. CFM  
P.E. No. 58660

No.	REVISIONS - SUBMITTALS	DATE
0	xx	00/00/00

SHEET No. **COVER** PAGE No. **1** OF **09**

**GENERAL NOTES:**

1. THE INFORMATION PROVIDED ON THE PLANS IS BASED ON THE BEST AVAILABLE INFORMATION AND SHOULD BE CONSIDERED APPROXIMATE. CONTRACTOR SHALL BE RESPONSIBLE FOR FAMILIARIZING HIMSELF WITH CURRENT SITE CONDITIONS, AND SHALL REPORT DISCREPANCIES TO THE ENGINEER PRIOR TO STARTING WORK.
2. THE PROJECT SCOPE OF WORK IS LIMITED TO SPEED TABLES AND/OR HUMPS FOR TRAFFIC CALMING PURPOSES AS PER THE CONSTRUCTION PLANS. ROAD AND DRAINAGE IMPROVEMENTS MAY BE CONSIDERED UNDER ANOTHER PROJECT AT THE DISCRETION OF THE CITY OF MIAMI.
3. SITE SURVEY IS NOT AVAILABLE AND WAS NOT CONDUCTED FOR THE DESIGN. THE PLAN SHEETS PROVIDE THE CONTRACTOR A GUIDE TO PERFORM THE WORK. THE SPECIFIC DETAILS AS TO THE LAYOUT AND PLACEMENT OF THE STREET IMPROVEMENTS WILL BE CLOSELY COORDINATED WITH THE CONSTRUCTION MANAGER. CONTRACTOR WILL NOT BEGIN CONSTRUCTION UNTIL THE EXACT LOCATION OF THE IMPROVEMENTS AND NECESSARY CONSTRUCTION WORK AREA HAS BEEN CLEARLY DEFINED AND AGREED TO BY THE CONSTRUCTION MANAGER.
4. CONTRACTOR WILL SECURE WORK SITE TO PROTECT THE PUBLIC HEALTH AND WELFARE.
5. THE CONTRACTOR WILL SECURE AND PAY FOR ALL PERMITS FOR THE WORK NECESSARY TO COMPLETE THIS PROJECT. CONTRACTOR SHALL COORDINATE EFFORTS WITH THE CITY'S PW DEPARTMENT.
6. THE CONTRACTOR SHALL BE RESPONSIBLE FOR ENSURING THAT ALL CONSTRUCTION SHALL BE DONE IN A SAFE MANNER AND IN STRICTLY COMPLIANCE WITH ALL THE REQUIREMENTS OF FEDERAL OCCUPATIONAL SAFETY AND HEALTH ACT OF 1970, AND ALL STATE AND LOCAL SAFETY AND HEALTH REGULATION.
7. CONTRACTOR TO REPAIR ALL DAMAGES INCURRED AS A RESULT OF CONSTRUCTION ACTIVITIES SUCH AS BUT NOT LIMITED TO SIDEWALK, PAVEMENT, LANDSCAPING, FENCING, ETC. NO ADDITIONAL COMPENSATION WILL BE GIVEN.
8. THE CONTRACTOR SHALL USE A STREET SWEEPER (USING WATER) OR OTHER EQUIPMENT FOR CONTROLLING AND REMOVING DUST. APPROVAL OF THE USE OF SUCH EQUIPMENT IS CONTINGENT UPON ITS DEMONSTRATED ABILITY TO DO THE WORK. CLEANING AND SWEEPING IS TO BE INCLUDED IN CONTRACTORS MAINTENANCE OF TRAFFIC PAY ITEM AND SHALL BE DONE ON A DAILY BASIS.
9. ALL PUBLIC LAND CORNERS AND MONUMENTS WITHIN THE LIMITS OF CONSTRUCTION SHALL BE PROTECTED BY THE CONTRACTOR AS FOLLOWS: CORNERS AND MONUMENTS IN CONFLICT WITH THE WORK AND IN DANGER OF BEING DAMAGED, DESTROYED OR COVERED SHALL BE PROPERLY REFERENCED BY A REGISTERED LAND SURVEYOR IN ACCORDANCE WITH THE MINIMUM TECHNICAL STANDARDS OF THE FLORIDA BOARD OF PROFESSIONAL LAND SURVEYORS. PRIOR TO BEGINNING WORK AT THE SITE, THE CONTRACTOR SHALL RETAIN THE LAND SURVEYOR TO REFERENCE, AND RESTORE UPON COMPLETION OF THE WORK, ALL SUCH CORNERS AND MONUMENTS AND SHALL FURNISH THE ENGINEER A SIGNED AND SEALED COPY OF THE LAND SURVEYOR'S REFERENCE DRAWING. COST OF THIS WORK SHALL BE DEEMED INCIDENTAL TO THE TOTAL PROJECT COST.
10. THE CONTRACTOR SHALL NOTIFY THE CITY IN WRITING AT LEAST 48 HOURS PRIOR TO COMMENCEMENT OF CONSTRUCTION.
11. THE CONTRACTOR SHALL BE RESPONSIBLE FOR PROVIDING A PROPER STAGING AREA APPROVED BY THE CITY. STOCKPILING OF MATERIAL IN ROADWAY IS NOT ALLOWED.
12. THE CONTRACTOR SHALL BE RESPONSIBLE TO SATISFY ALL REQUIREMENTS OF ANY REGULATORY AGENCY PERMITS IN REGARDS TO CONSTRUCTION ACTIVITIES AND RELATED CONDITIONS PRIOR TO THE START OF CONSTRUCTION.
13. THE CONTRACTOR SHALL MAINTAIN PEDESTRIAN AND VEHICULAR ACCESS TO ALL ADJACENT PROPERTIES AT ALL TIMES UNLESS OTHERWISE APPROVED BY THE CITY.
14. THE CONTRACTOR SHALL NOT ENCROACH INTO PRIVATE PROPERTY WITH PERSONNEL, MATERIAL OR EQUIPMENT.
15. THE CONTRACTOR SHALL VERIFY, PHOTOGRAPH, AND INVENTORY THE EXACT LOCATION OF ALL EXISTING TREES, STRUCTURES, PAVEMENT OR OTHER FEATURES. ANY EXISTING STRUCTURE, PAVEMENT, TREE OR OTHER EXISTING FEATURE, WHICH IS IN CONFLICT OR IS DAMAGED, EXPOSED OR IN ANY WAY DISTURBED BY CONSTRUCTION PERFORMED UNDER THE CONTRACT, SHALL BE RESTORED PROMPTLY TO IT'S ORIGINAL CONDITION AT NO ADDITIONAL COST TO THE PROJECT.
16. THE CONTRACTOR SHALL NOTIFY THE CITY OF MIAMI'S CONSTRUCTION MANAGER IMMEDIATELY OF ANY CONFLICT ARISING DURING CONSTRUCTION FOR ANY IMPROVEMENTS SHOWN ON THESE DRAWINGS.
17. THE CONSTRUCTION LAYOUT SHALL BE THE RESPONSIBILITY OF THE CONTRACTOR.

18. ALL EXISTING MANHOLE TOPS, CATCH BASIN GRATES, VALVE BOX TOPS, AND WATER METER TOPS WITHIN THE PROJECT AREA SHALL BE ADJUSTED TO MATCH FINISHED GRADE BY CITY CONTRACTOR. PLANS MAY NOT SHOW ALL LOCATIONS NECESSARY FOR ADJUSTMENTS. CONTRACTOR IS RESPONSIBLE FOR LOCATING ALL NECESSARY UTILITY TOPS TO BE ADJUSTED.
19. CONTRACTOR TO RESTORE ALL SODDED AREAS OF THE PROJECT WHICH ARE DISTURBED DUE TO CONSTRUCTION ACTIVITIES.
20. ALL PROPOSED WORK SHALL BE PERFORMED WITHIN THE LIMITS OF THE EXISTING LOCAL RIGHT-OF-WAY.
21. THE CONTRACTOR SHALL ASSIST THE CITY WITH THE HANDLING OF PUBLIC INFORMATION MATERIALS, INCLUDING CITIZEN NOTIFICATION LETTERS AND PROJECT CONSTRUCTION SIGNS, PRIOR TO THE START OF EACH SIGNIFICANT PHASE OF CONSTRUCTION. COST OF THIS WORK SHALL BE INCLUDED IN THE MAINTENANCE OF TRAFFIC BID ITEM.
22. IN CASE REPLACEMENT OF CURB, GUTTER AND DRIVEWAY IS NECESSARY THE CONTRACTOR SHALL USE CITY OF MIAMI PUBLIC WORKS ENGINEERING STANDARDS FOR DESIGN AND CONSTRUCTION.

**ENVIRONMENTAL NOTES:**

23. DUE TO THE LIMITED SCOPE OF WORK, NO IMPACTS TO EXISTING HISTORICAL AND CULTURAL RESOURCES ARE EXPECTED AS A RESULT OF THE PROPOSED ACTION.
24. NO STAGING OR OTHER ACTIVITIES FOR THIS PROJECT SHOULD OCCUR WITHIN THE DRIPLINE OF EXISTING TREES.
25. PREVENT DAMAGING TREES AND PLANTERS WITHIN OR IMMEDIATELY ADJACENT TO THE PROJECT'S RIGHT-OF-WAY.
26. AN ARBORIST CERTIFIED BY THE INTERNATIONAL SOCIETY OF ARBORICULTURE SHALL BE PRESENT ON SITE TO DIRECT ALL ROOT PRUNING AND/OR CANOPY TRIMMING ACTIVITIES.
27. TREE PROTECTION SHOULD BE INSTALLED AROUND TREES TO REMAIN LOCATED ADJACENT TO CONSTRUCTION ACTIVITIES.

**PRE-CONSTRUCTION RESPONSIBILITIES:**

28. PRIOR TO THE COMMENCEMENT OF THE CONSTRUCTION AND THE RECEIPT OF THE "NOTICE TO PROCEED", THE CONTRACTOR SHALL CONTACT THE CIP CONSTRUCTION MANAGER AND ARRANGE A PRE-CONSTRUCTION CONFERENCE TO INCLUDE THE ENGINEER OF RECORD. THE CONTRACTOR SHALL SUBMIT A CONSTRUCTION SCHEDULE AND BE PREPARED TO DISCUSS ANY CONCERNS OR COORDINATION EFFORTS AND REQUIREMENTS WITH THE PARTIES INVOLVED.
29. THE CONTRACTOR SHALL OBTAIN A SUNSHINE STATE ONE CALL OF FLORIDA, INC. CERTIFICATION NUMBER AT LEAST 48 HOURS PRIOR TO BEGINNING ANY EXCAVATION. CONTACT 811, WWW.CALLSUNSHINE.COM

**UTILITIES:**

30. TWO FULL BUSINESS DAYS PRIOR TO DIGGING, THE CONTRACTOR SHALL CONTACT 811, WWW.CALLSUNSHINE.COM TO REQUEST UTILITY LOCATIONS BEFORE BEGINNING ANY CONSTRUCTION ACTIVITIES.
31. EXISTING UTILITIES SHALL BE MAINTAINED IN SERVICE DURING CONSTRUCTION UNLESS OTHERWISE APPROVED BY THE UTILITY OWNER. ALL EXISTING UTILITIES ARE TO REMAIN UNLESS OTHERWISE NOTED.
32. IT SHALL BE THE CONTRACTOR'S SOLE RESPONSIBILITY TO (VERTICALLY AND HORIZONTALLY) PROTECT AND ALL EXISTING UTILITIES ON THIS PROJECT. ANY DAMAGE TO UTILITIES SHALL BE IMMEDIATELY REPORTED TO THE UTILITY OWNER. THE OWNER RESERVES THE RIGHT TO REMEDY SUCH DAMAGE BY ORDERING OUTSIDE PARTIES TO MAKE SUCH REPAIRS AT THE EXPENSE TO THE CONTRACTOR.
33. THE CONTRACTOR IS ADVISED THAT PROPERTIES ADJACENT TO THE PROJECT HAVE ELECTRIC, TELEPHONE, GAS, WATER AND/OR SEWER SERVICE LATERALS WHICH MAY NOT BE SHOWN IN PLANS. THE CONTRACTOR MUST REQUEST THE LOCATION OF THESE LATERAL SERVICES FROM THE UTILITY COMPANIES. THE ADDITIONAL COST OF EXCAVATING, INSTALLING, BACKFILLING AND COMPACTING AROUND THESE LATERAL SERVICES MUST BE INCLUDED IN THE BID RELATED ITEM FOR THE WORK BEING DONE.

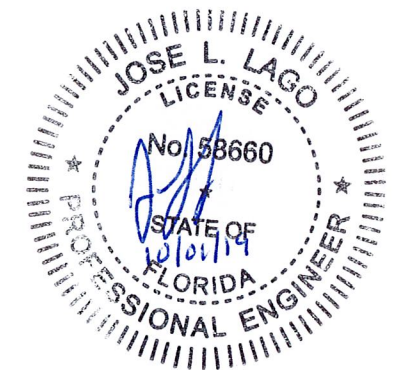

**CITY OF MIAMI**  
**OFFICE OF CAPITAL IMPROVEMENTS**  
 444 S.W. 2ND AVENUE, 8TH FLOOR  
 MIAMI, FLORIDA 33130  
 (305) 416-1280 - FAX (305) 416-1253

REVISIONS		
DATE	BY	DESCRIPTION

JOSE L. LAGO, P.E., CFM  
 CITY OF MIAMI - PM  
 P.E. No. 58660

<b>CITY OF MIAMI</b> OFFICE OF CAPITAL IMPROVEMENTS	
PROJECT NAME	PROJECT No.
THE ROADS NEIGHBORHOOD TRAFFIC CALMING	B- 193619

**GENERAL NOTES**

SHEET NO.  
**2**

**NOTES:**

1. REFER TO DETAIL 2 ON SHEET 4 FOR THIS SPEED HUMP.
2. ALL CURB AND GUTTERS TO BE REPLACED SHALL BE COMPLY WITH CITY OF MIAMI PUBLIC WORKS ENGINEERING STANDARD 35-85-22.
3. CONTRACTOR TO VERIFY EXACT LOCATION OF SIGNS TO AVOID DRIVEWAY APPROACH.
4. SITE SURVEY IS NOT AVAILABLE AND WAS NOT CONDUCTED FOR THE DESIGN. THE PLAN SHEETS PROVIDE THE CONTRACTOR A GUIDE TO PERFORM THE WORK. THE SPECIFIC DETAILS AS TO THE LAYOUT AND PLACEMENT OF THE STREET IMPROVEMENTS WILL BE CLOSELY COORDINATED WITH THE CONSTRUCTION MANAGER. CONTRACTOR WILL NOT BEGIN CONSTRUCTION UNTIL THE EXACT LOCATION OF THE IMPROVEMENTS AND NECESSARY CONSTRUCTION WORK AREA HAS BEEN CLEARLY DEFINED AND AGREED TO BY THE CONSTRUCTION MANAGER.
5. ALL DISTURBED AREAS RESULTING FROM CONSTRUCTION ACTIVITIES SHALL BE RESTORED.
6. MILLING AND RESURFACING:  
TYPE SP-9.5 ASPHALT (1") (110 LBS/SY AVG) (INCL. TACK COAT)
7. CONTRACTOR TO INSTALL TREE PROTECTION AROUND TREES THAT ARE LOCATED ADJACENT TO CONSTRUCTION ACTIVITIES.

**LEGEND**

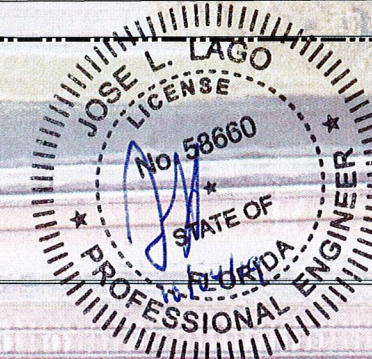
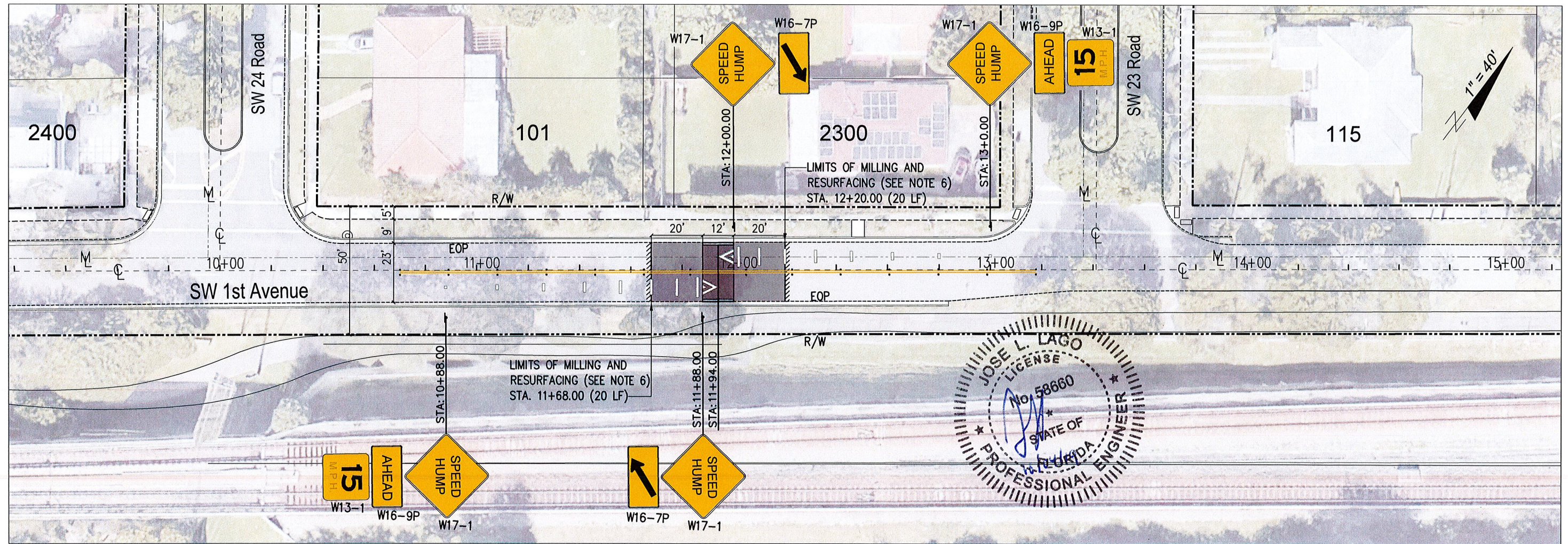
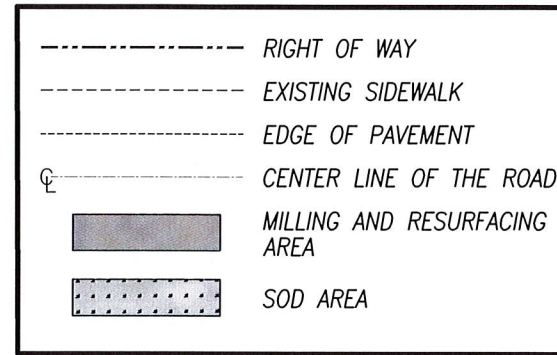

**CITY OF MIAMI**  
OFFICE OF CAPITAL IMPROVEMENTS  
444 S.W. 2ND AVENUE, 8TH FLOOR  
MIAMI, FLORIDA 33130  
(305) 416-1280 - FAX (305) 416-1253

REVISIONS		
DATE	BY	DESCRIPTION

JOSE L. LAGO, P.E., CFM  
CITY OF MIAMI - PM  
P.E. No. 58660

**CITY OF MIAMI**  
OFFICE OF CAPITAL IMPROVEMENTS  
PROJECT NAME: THE ROADS NEIGHBORHOOD TRAFFIC CALMING  
PROJECT No.: B- 193619

TRAFFIC CALMING DEVICE No. 1  
SPEED HUMP PLAN VIEW  
SW 1st AVE. FROM SW 24th RD. TO 23rd RD.

SHEET NO.  
**3**

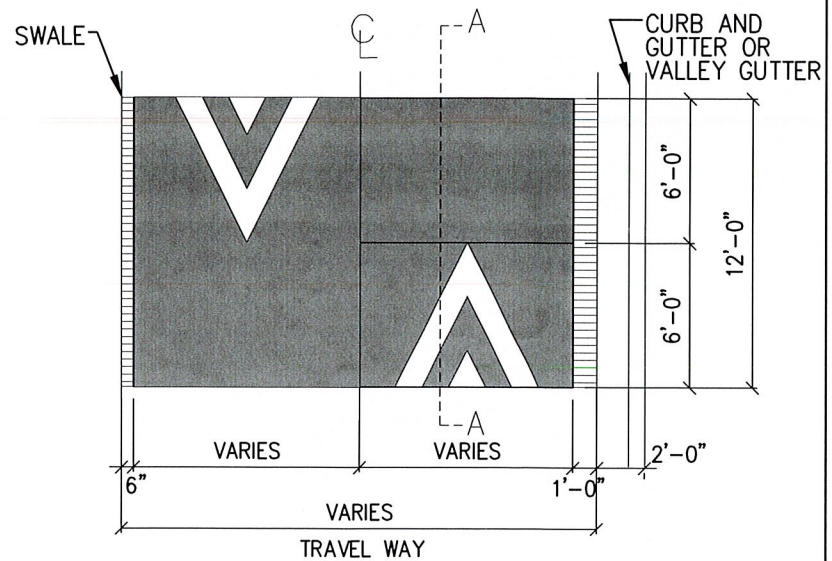

PLAN VIEW

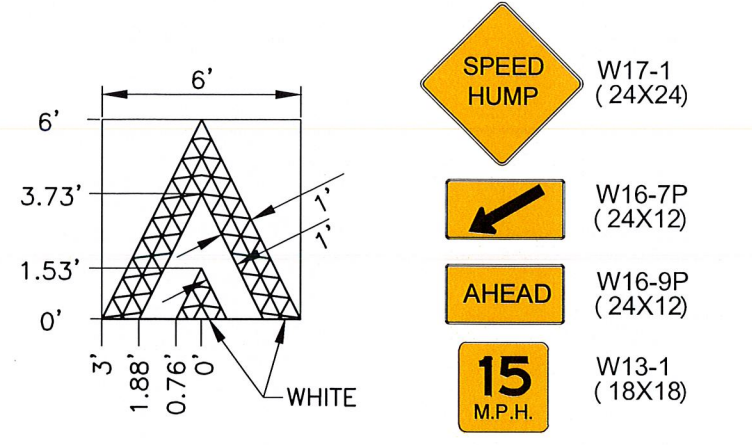

SECTION A

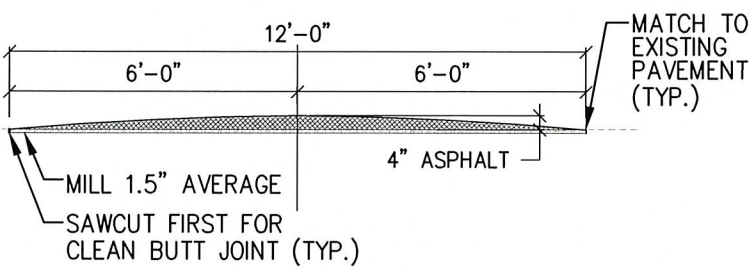

PARABOLIC SPEED HUMP \_\_\_ N.T.S.

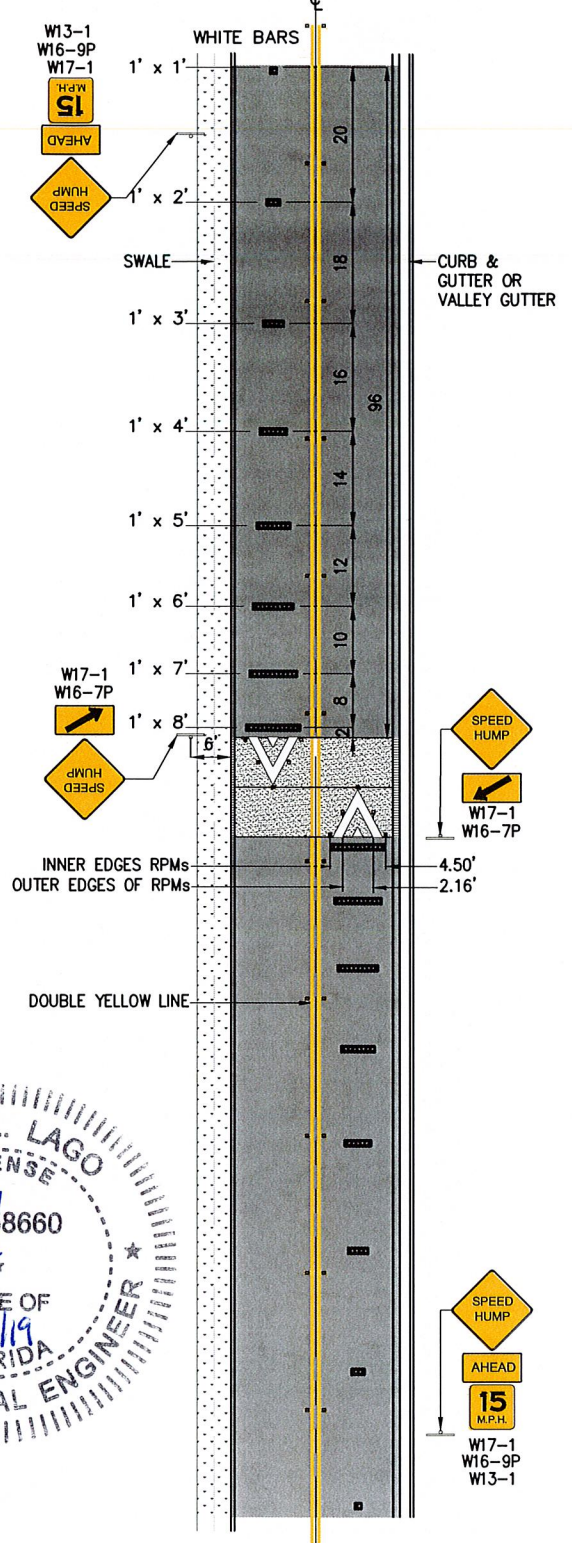

PAVEMENT MARKING & SIGNS DETAILS \_\_\_ N.T.S.

- GENERAL NOTES:**
1. SPEED HUMP SHALL NOT BE LOCATED IN FRONT OF DRIVEWAY.
  2. FOR SIGNAGE LOCATIONS, REFER TO SHEET No. 3. CITY OF MIAMI CONSTRUCTION MANAGER MAY SELECT OTHER LOCATIONS NEAR THE SPEED TABLE SHOULD THERE BE ANY CONFLICTS AND AT THE DISCRETION OF THE ENGINEER OF RECORD.
  3. SPEED HUMP SHALL NOT BE PLACED OVER MANHOLES, WATER VALVES, SURVEY MONUMENTS, OR ANY UTILITY FEATURES.
- REFERENCE:**
4. MUTCD SECTION-3B.25 & 3B.26.
  5. (24) BIDIRECTIONAL YELLOW REFLECTIVE PAVEMENT MARKERS FOR DOUBLE YELLOW LINE & (10) BIDIRECTIONAL WHITE/RED REFLECTIVE PAVEMENT MARKERS FOR SPEED HUMP AS SHOWN.
  6. ALL RPM'S SHALL BE OFFSET 1" FROM SOLID LONGITUDINAL LINES.
  7. ALL RPM'S SHALL BE CLASS "B"
- DRAINAGE NOTE:**
8. HUMP TO BE AT LEAST 3" AWAY FROM THE EDGE OF PAVEMENT ON BOTH SIDES IN ORDER TO ALLOW PROPER FLOW OF RUNOFF INTO THE EXISTING CATCH BASINS.
  9. REGRADE EXISTING SWALE IF NEEDED.
- SIGN:**
10. LOCATE SPEED HUMP AND SIGNS TO MINIMIZE IMPACT ON DRIVEWAYS.
  11. REMOVE ALL SIGNING AND MARKING IN CONFLICT WITH THE DESIGN.
- PAINT:**
12. 250' OF 6" DOUBLE YELLOW LINE THERMOPLASTIC PAINT EACH SPEED HUMP.
  13. 100' OF 12" WHITE LINE THERMOPLASTIC PAINT EACH SPEED HUMP.

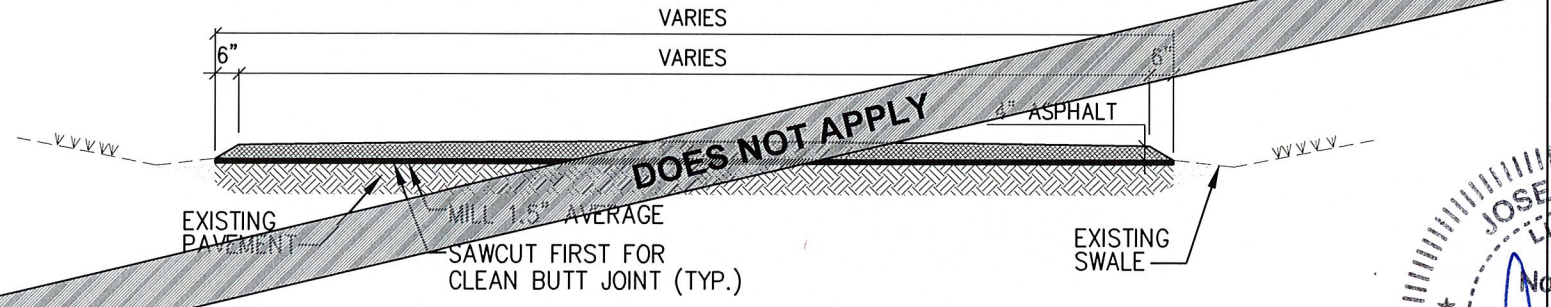

DETAIL 1 - CROSS SECTION - SWALE \_\_\_ N.T.S.

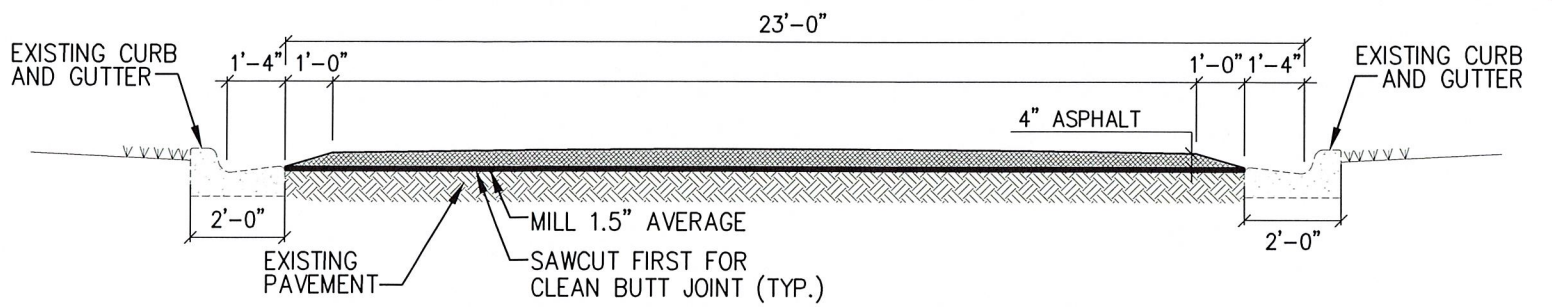

DETAIL 2 - CROSS SECTION - CURB AND GUTTER OR VALLEY GUTTER \_\_\_ N.T.S.

SPEED HUMP No	LOCATION	LANE WIDTH	NOTES
1	ALONG SW 1st AVENUE FROM SW 24th Rd TO SW 23rd Rd	23'	DETAIL 2 -EXISTING CURB AND GUTTER TO REMAIN.

REVISIONS		
DATE	BY	DESCRIPTION

JOSE L. LAGO, P.E., CFM  
CITY OF MIAMI - PM  
P.E. No. 58660

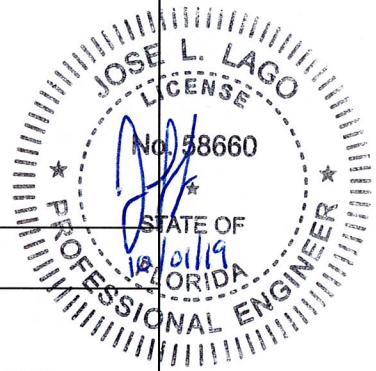

**NOTES:**

- REFER TO DETAIL 1 ON SHEET 6 FOR THIS SPEED TABLE.
- ALL CURB AND GUTTERS TO BE REPLACED SHALL BE COMPLY WITH CITY OF MIAMI PUBLIC WORKS ENGINEERING STANDARD 35-85-22.
- CONTRACTOR TO VERIFY EXACT LOCATION OF SIGNS TO AVOID DRIVE WAY APPROACH.
- SITE SURVEY IS NOT AVAILABLE AND WAS NOT CONDUCTED FOR THE DESIGN. THE PLAN SHEETS PROVIDE THE CONTRACTOR A GUIDE TO PERFORM THE WORK. THE SPECIFIC DETAILS AS TO THE LAYOUT AND PLACEMENT OF THE STREET IMPROVEMENTS WILL BE CLOSELY COORDINATED WITH THE CONSTRUCTION MANAGER. CONTRACTOR WILL NOT BEGIN CONSTRUCTION UNTIL THE EXACT LOCATION OF THE IMPROVEMENTS AND NECESSARY CONSTRUCTION WORK AREA HAS BEEN CLEARLY DEFINED AND AGREED TO BY THE CONSTRUCTION MANAGER.
- ALL DISTURBED AREAS RESULTING FROM CONSTRUCTION ACTIVITIES SHALL BE RESTORED.
- MILLING AND RESURFACING:  
TYPE SP-9.5 ASPHALT (1") (110 LBS/SY AVG) (INCL. TACK COAT)
- CONTRACTOR TO INSTALL TREE PROTECTION AROUND TREES THAT ARE LOCATED ADJACENT TO CONSTRUCTION ACTIVITIES.

**LEGEND**

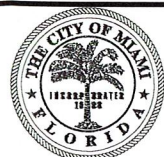
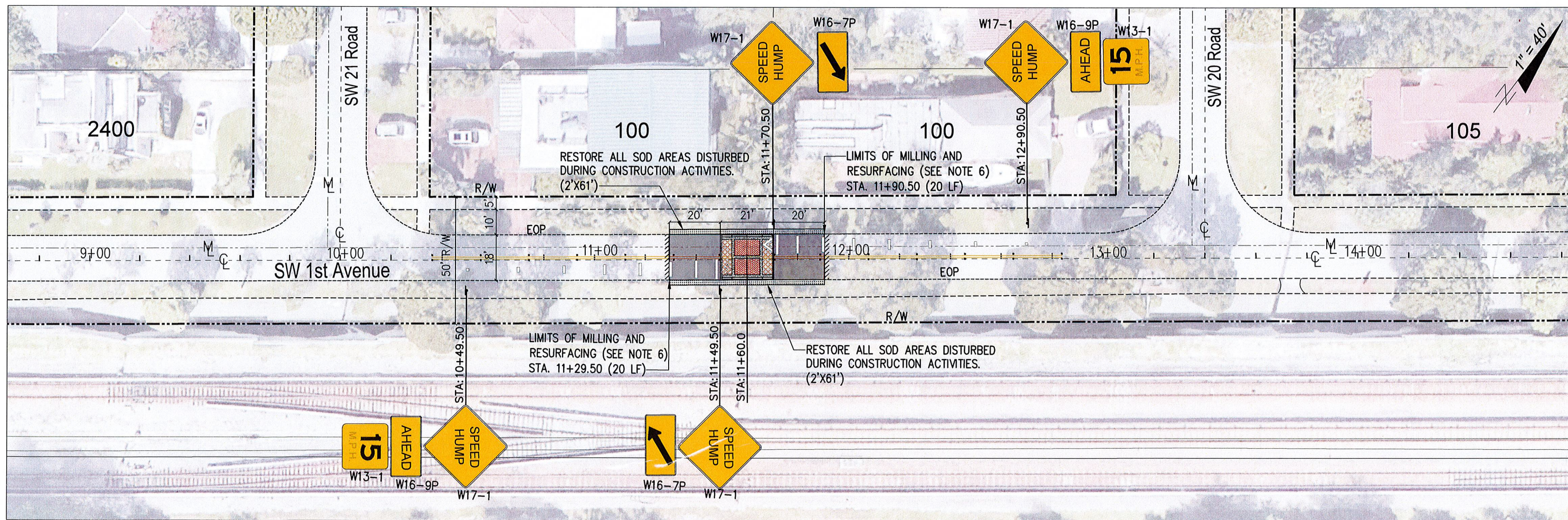
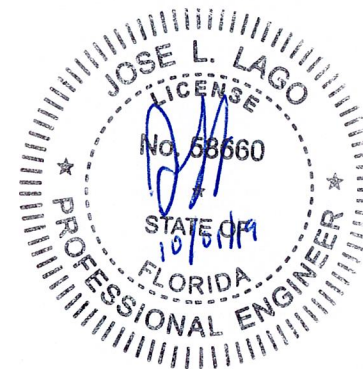
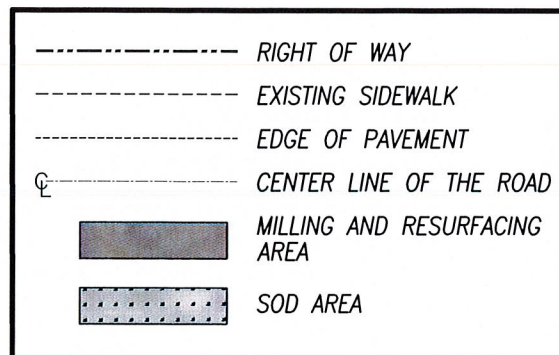

**CITY OF MIAMI**  
OFFICE OF CAPITAL IMPROVEMENTS  
444 S.W. 2ND AVENUE, 8TH FLOOR  
MIAMI, FLORIDA 33130  
(305) 416-1280 - FAX (305) 416-1253

REVISIONS		DESCRIPTION
DATE	BY	

JOSE L. LAGO, P.E., CFM  
CITY OF MIAMI - PM  
P.E. No. 58660

CITY OF MIAMI OFFICE OF CAPITAL IMPROVEMENTS	
PROJECT NAME THE ROADS NEIGHBORHOOD TRAFFIC CALMING	PROJECT No. B- 193619

TRAFFIC CALMING DEVICE No. 2  
SPEED TABLE PLAN VIEW  
SW 1st AVE. FROM SW 21st RD. TO 20th RD.

SHEET NO.  
**5**

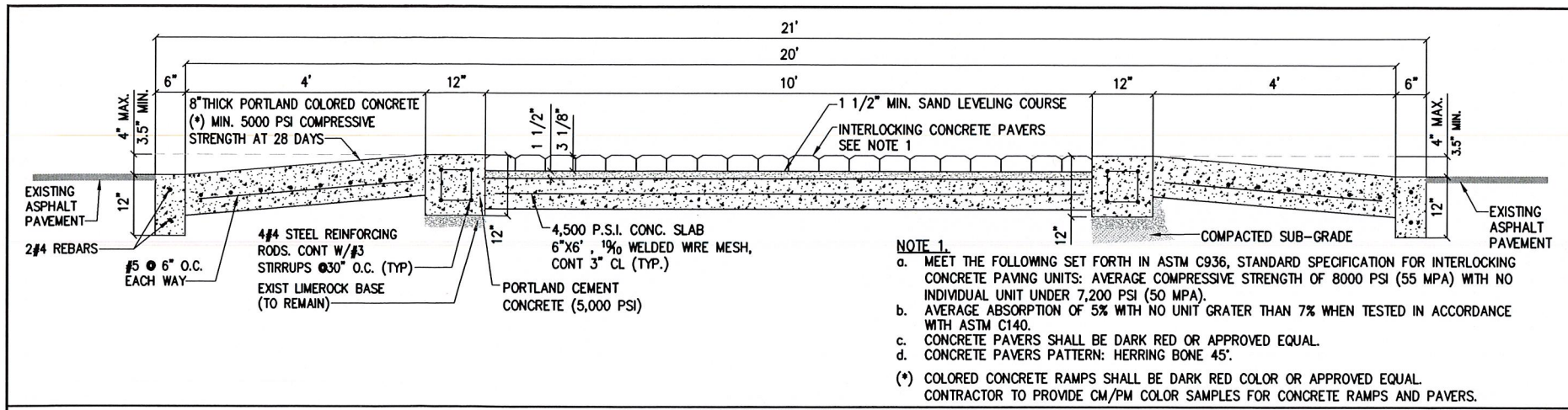

**NOTE 1.**

- MEET THE FOLLOWING SET FORTH IN ASTM C936, STANDARD SPECIFICATION FOR INTERLOCKING CONCRETE PAVING UNITS: AVERAGE COMPRESSIVE STRENGTH OF 8000 PSI (55 MPA) WITH NO INDIVIDUAL UNIT UNDER 7,200 PSI (50 MPA).
- AVERAGE ABSORPTION OF 5% WITH NO UNIT GRATER THAN 7% WHEN TESTED IN ACCORDANCE WITH ASTM C140.
- CONCRETE PAVERS SHALL BE DARK RED OR APPROVED EQUAL.
- CONCRETE PAVERS PATTERN: HERRING BONE 45°.

(\*) COLORED CONCRETE RAMPS SHALL BE DARK RED COLOR OR APPROVED EQUAL. CONTRACTOR TO PROVIDE CM/PM COLOR SAMPLES FOR CONCRETE RAMPS AND PAVERS.

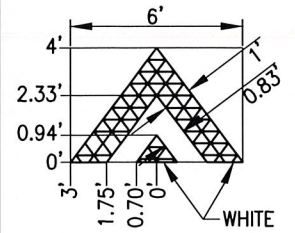
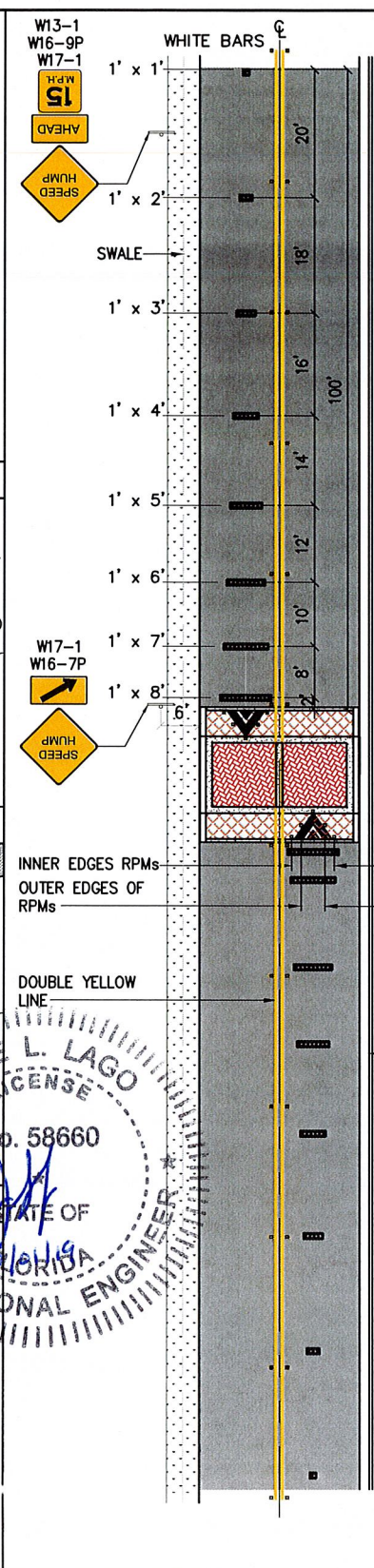
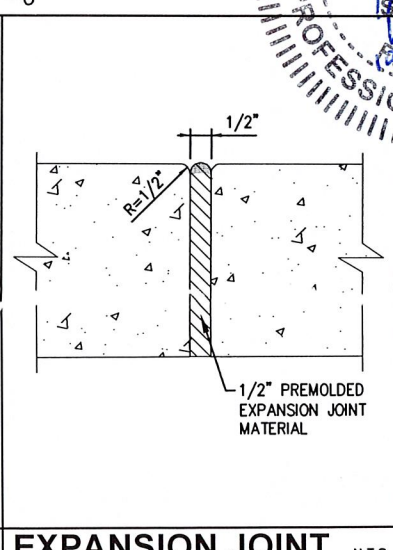
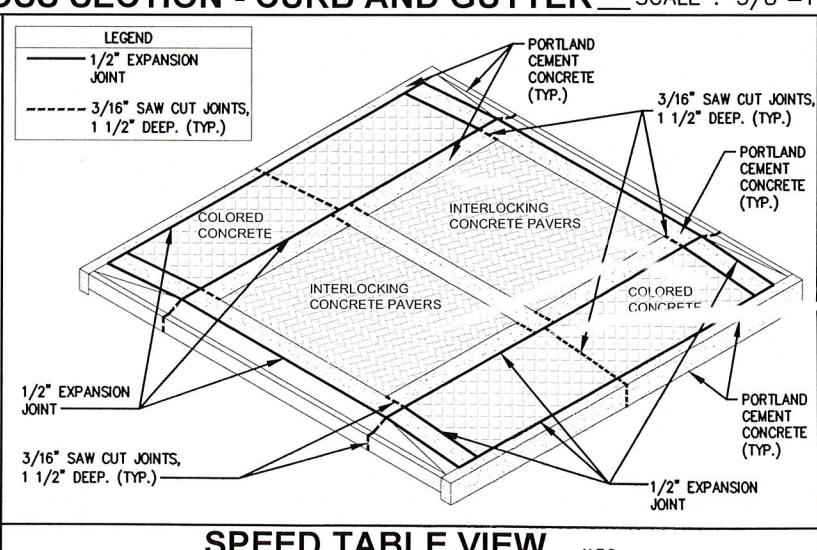
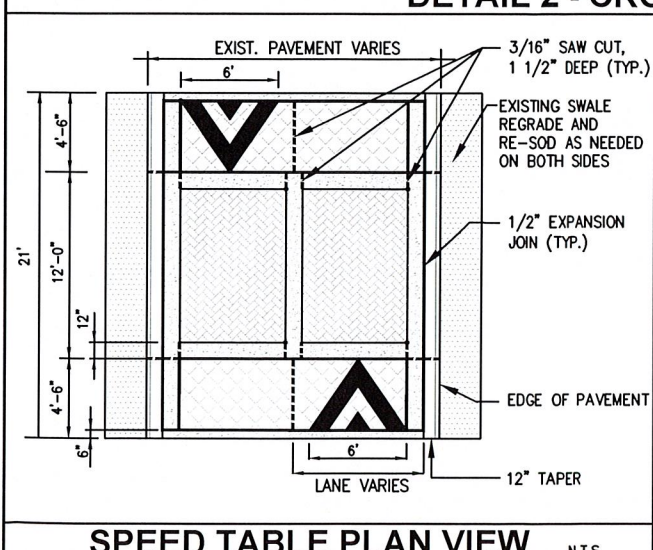
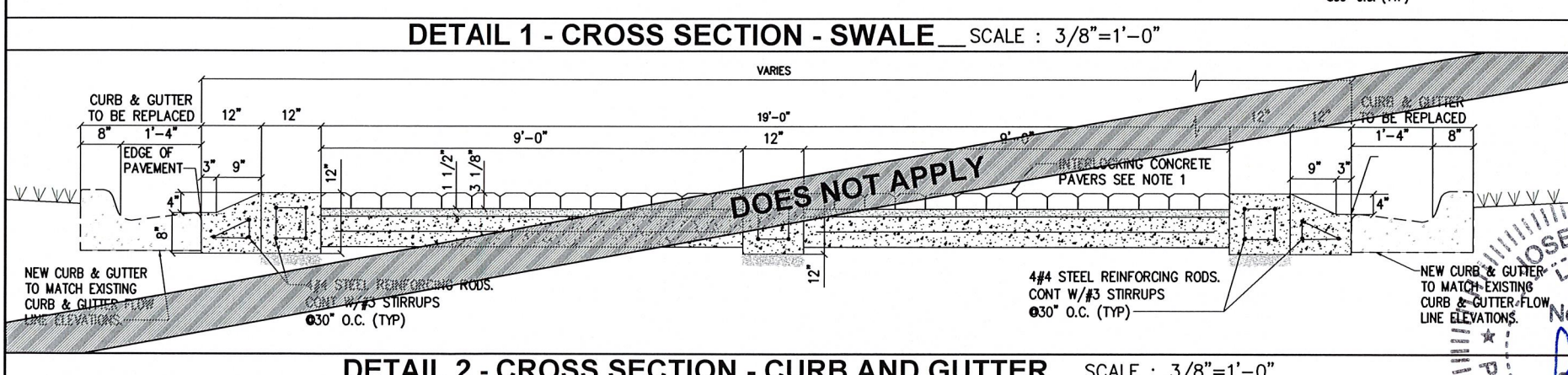
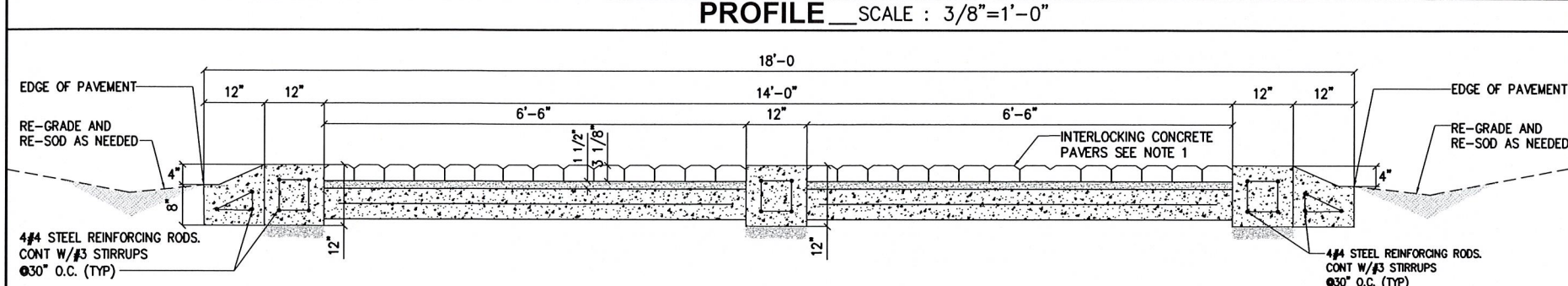

**GENERAL NOTES:**

- SPEED TABLE SHALL NOT BE LOCATED IN FRONT OF DRIVEWAY.
- FOR SIGNAGE LOCATIONS, REFER TO SHEET No. 5. CITY OF MIAMI CONSTRUCTION MANAGER MAY SELECT OTHER LOCATIONS NEAR THE SPEED TABLE SHOULD THERE BE ANY CONFLICTS AND AT THE DISCRETION OF THE ENGINEER OF RECORD.
- SPEED TABLES SHALL NOT BE PLACED OVER MANHOLES, WATER VALVES, SURVEY MONUMENTS, OR ANY UTILITY FEATURES.

**REFERENCE:**

- MUTCD SECTION-3B.25 & 3B.26.
- (24) BI-DIRECTIONAL YELLOW REFLECTIVE PAVEMENT MARKERS FOR DOUBLE YELLOW LINE & (10) BI-DIRECTIONAL WHITE/RED REFLECTIVE PAVEMENT MARKERS FOR SPEED TABLE AS SHOWN.
- ALL RPM'S SHALL BE OFFSET 1" FROM SOLID LONGITUDINAL LINES.
- ALL RPM'S SHALL BE CLASS "B" TYPE.

**DRAINAGE NOTE:**

- NEW CURB AND GUTTER FLOW LINES TO MATCH EXISTING IN ORDER TO ALLOW PROPER FLOW OF RUNOFF INTO THE EXISTING CATCH BASINS.
- REGRADE EXISTING SWALE IF NEEDED.

**SIGN:**

- LOCATE SPEED TABLE AND SIGNS TO MINIMIZE IMPACT ON DRIVEWAYS.
- REMOVE ALL EXISTING SIGNING AND MARKING IN CONFLICT WITH THE PROPOSED DESIGN.

**PAINT:**

- APPLY NEW THERMOPLASTIC PAVEMENT MARKINGS:
  - 250' OF 2-6" YELLOW EACH TABLE.
  - 100' OF 12" WHITE EACH TABLE.
- BEFORE APPLYING PAVEMENT MARKING TO ANY PORTLAND CEMENT CONCRETE SURFACE, APPLY A PRIMER, SEALER, OR SURFACE PREPARATION ADHESIVE OF THE TYPE RECOMMENDED BY THE MANUFACTURER.

PAVEMENT MARKING & SIGNS DETAILS N.T.S.			
SPEED TABLE No	LOCATION	LANE WIDTH	NOTES
2	ALONG SW 1st AVENUE FROM 21st Rd. TO SW 20th Rd.	18'	DET. 1 - SWALE

REVISIONS		
DATE	BY	DESCRIPTION

JOSE L. LAGO, P.E., CFM  
CITY OF MIAMI - PM  
P.E. No. 58660

**CITY OF MIAMI**  
OFFICE OF CAPITAL IMPROVEMENTS  
PROJECT NAME: THE ROADS NEIGHBORHOOD TRAFFIC CALMING  
PROJECT No.: B- 193619

**TRAFFIC CONTROL PLANS:**

1. TRAFFIC CONTROLS SHALL BE IN ACCORDANCE WITH THE PROJECT PLANS, THE CURRENT EDITION OF THE FLORIDA DOT DESIGN STANDARDS (600 SERIES), THE STANDARD SPECIFICATION FOR ROAD AND BRIDGE CONSTRUCTION, AND THE MANUAL ON UNIFORM TRAFFIC CONTROL DEVICES AS MINIMUM CRITERIA.
2. NOTIFICATION OF LANE CLOSURES OR TEMPORARY DETOURS SHALL BE ACCOMPLISHED 14 WORKING DAYS PRIOR TO CLOSURE. DETOUR OR MOT PHASE CHANGE SHALL BE SUBMITTED WITH THE REQUIRED LANE CLOSURE FORM, SKETCHES, CALCULATIONS, AND OTHER DATA TO PUBLIC WORKS DEPT.
3. AT THE DISCRETION OF THE ENGINEER, IF A LANE CLOSURE CAUSES EXTENDED CONGESTION OR DELAY, THE CONTRACTOR SHALL BE DIRECTED TO REOPEN THE CLOSED LANE(S) UNTIL SUCH TIME THAT THE TRAFFIC FLOW HAS RETURNED TO AN ACCEPTABLE LEVEL.
4. THE TRAFFIC AND TRAVEL WAYS SHALL NOT BE ALTERED BY THE CONTRACTOR TO CREATE A WORK ZONE UNTIL ALL LABOR AND MATERIAL ARE AVAILABLE FOR THE CONSTRUCTION IN THAT AREA.
5. LANE CLOSURE SHALL OCCUR ONLY DURING NON-PEAK HOURS ON NON-EVENT DAYS/NIGHTS/WEEKENDS. NON-PEAK HOURS ARE: 9:00 AM TO 3:30 PM WEEKDAYS AND SATURDAYS. EXCEPTIONS MAY BE GRANTED UPON WRITTEN REQUEST TO THE CITY.
6. TRAFFIC CONTROL PLANS FOR ALL PHASES ARE DESIGNED FOR NON-PEAK HOURS ONLY. THE CONTRACTOR SHALL KEEP ALL EXISTING LANES OPEN DURING PEAK HOURS IN THESE PHASES.
7. AS DETERMINED BY THE ENGINEER, THE CONTRACTOR SHALL COVER WORK ZONE SIGNS WHEN CONDITIONS NO LONGER WARRANT THEIR USE. COST OF COVERING AND UNCOVERING THE SIGNS SHALL BE INCLUDED IN MAINTENANCE OF TRAFFIC PAY ITEM.
8. ALL TEMPORARY STRIPES AND MARKINGS SHALL BE PAINT ONLY, UNLESS OTHERWISE SPECIFIED ON THE PLANS OR APPROVED BY THE ENGINEER. COST OF TEMPORARY STRIPING SHALL BE INCLUDED IN MOT PAY ITEM.
9. EACH EXISTING STREET NAME AND STOP SIGN AFFECTED BY CONSTRUCTION SHALL BE RELOCATED AND MAINTAINED IN AN APPROPRIATE LOCATION FOR THE DURATION OF THE PROJECT. WHEN NO LONGER AFFECTED BY CONSTRUCTION, THESE SIGNS SHALL BE RESTORED TO THEIR ORIGINAL POSITION. COST OF TEMPORARILY RELOCATING AND RESTORING THE SIGNS SHALL BE INCLUDED IN MAINTENANCE OF TRAFFIC PAY ITEM.
10. CONTRACTOR SHALL PREPARE AND SUBMIT AN ACCEPTABLE MOT PLAN FOR THE PROJECT. THE MOT PLAN SHALL BE SUBMITTED TO THE CITY OF MIAMI'S PUBLIC WORKS DEPARTMENT FOR REVIEW AND APPROVAL.
11. LANE CLOSURES SHALL NOT BE PERMITTED DURING SCHOOL SPEED ZONE HOURS WHERE SUCH CLOSURES WILL AFFECT TRAFFIC FLOW IN THE VICINITY OF THE SCHOOL SPEED ZONES.

**WORK ZONE LIMITS:**

12. NO MORE THAN TWO BLOCKS OF STREET SHALL BE UNDER CONSTRUCTION AT A TIME AND ALL WORK AND RESTORATION SHALL BE COMPLETED ON ONE OF SUCH BLOCKS BEFORE WORK MAY BEGIN IN A NEW BLOCK. FINAL RESURFACING SHALL BE PLACED WITHIN 48 HOURS OF THE MILLING OPERATION.

**PEDESTRIANS, BICYCLES, AND WHEELCHAIRS:**

13. AT THE END OF EACH WORK DAY OR WHENEVER THE WORK ZONE BECOMES INACTIVE, ANY DROP OFF GREATER THAN 6 IN. ADJACENT TO THE PEDESTRIAN, BICYCLE, AND WHEELCHAIR TRAVEL PATHS SHALL BE BACKFILLED FLUSH WITH THE SAID PATHS OR PROTECTED WITH TEMPORARY FENCE, CONCRETE BARRIER WALL OR APPROVED HANDRAIL. COST SHALL BE INCLUDED IN MAINTENANCE OF TRAFFIC PAY ITEM.
14. CONSTRUCTION ACTIVITIES THAT INVOLVES SIDEWALKS ON BOTH SIDES OF THE STREET ARE NOT ALLOWED UNLESS APPROVED BY THE ENGINEER.
15. MAINTAIN PEDESTRIAN ACCESS TO BUS STOP LOCATIONS IN PROJECT AREA. IF BUS STOP MUST BE RELOCATED, PLEASE CONTACT MRS. JUDY EMERSON MDTA AT (786) 469-5073, AND NATALIA ONIKIENKO PUBLIC WORKS AT (305) 416-1287.

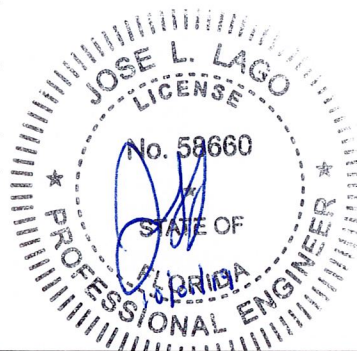

**CITY OF MIAMI**  
 OFFICE OF CAPITAL IMPROVEMENTS  
 444 S.W. 2ND AVENUE, 8TH FLOOR  
 MIAMI, FLORIDA 33130  
 (305) 416-1280 - FAX (305) 416-1253

REVISIONS		
DATE	BY	DESCRIPTION

JOSE L. LAGO, P.E., CFM  
 CITY OF MIAMI - PM  
 P.E. No. 58660

CITY OF MIAMI OFFICE OF CAPITAL IMPROVEMENTS	
PROJECT NAME	PROJECT No.
THE ROADS NEIGHBORHOOD TRAFFIC CALMING	B- 193619

TRAFFIC CONTROL PLAN (MOT)  
 NOTES

SHEET NO.  
 7

# SWPPP - NARRATIVE

## 1. PROJECT/SITE DESCRIPTION

### a. CONSTRUCTION ACTIVITY:

SPEED HUMP No. 1 -SW 1st AVENUE FROM SW 24th ROAD TO SW 23rd ROAD  
 SPEED TABLE No. 2 -SW 1st AVENUE FROM SW 21st ROAD TO SW 20th ROAD

### PROJECT LIMITS:

### PROJECT DESCRIPTION:

SPEED HUMP No. 1 -SW 1st AVENUE FROM SW 24th ROAD TO SW 23rd ROAD  
 SPEED TABLE No. 2 -SW 1st AVENUE FROM SW 21st ROAD TO SW 20th ROAD

### b. MAJOR SOIL DISTURBING ACTIVITIES:

- CLEARING & GRUBBING
- REGULAR EXCAVATION
- GRADING SLOPES
- REMOVAL OF EXISTING PAVEMENT
- DRAINAGE - STRUCTURE CONSTRUCTION
- BRIDGE DEMOLITION
- BRIDGE CONSTRUCTION
- EARTHWORK ASSOCIATED WITH DRAINAGE TRENCH EXCAVATION, CONCRETE CURB, CURB & GUTTER SUBGRADE, BASE, PAVEMENT AND SIDEWALK CONSTRUCTION
- ROADWAY CONSTRUCTION

FOR A DETAILED SEQUENCE OF CONSTRUCTION REFER TO THE TRAFFIC CONTROL PLANS.

### c. TOTAL PROJECT AREA:

LESS THAN 0.5 ACRE

### TOTAL AREA TO BE DISTURBED:

LESS THAN 0.5 ACRE

### d. (1) RUNOFF COEFFICIENTS BEFORE, DURING, AND AFTER CONSTRUCTION:

IMPERVIOUS AREA CN=.98  
 PERVIOUS AREA CN=.93

### (2) DESCRIPTION OF SOIL OR QUALITY OF DISCHARGE:

N/A

### (3) ESTIMATES OF SIZE OF DRAINAGE AREA FOR EACH OUTFALL:

N/A

### e. FOR LOCATIONS OF DRAINAGE AREAS AND OUTFALLS :

N/A

### f. (1) NAME OF RECEIVING WATERS:

N/A

### (2) WETLAND AREA:

N/A

## 2. CONTROLS

NARRATIVE - SEQUENCE OF SOIL DISTURBING ACTIVITIES AND IMPLEMENTATION OF CONTROLS:  
 PRIOR TO THE START OF CLEARING AND GRUBBING OPERATIONS, SILT FENCE, WIND SCREEN AND SYNTHETIC BALES SHALL BE INSTALLED AS SHOWN ON THE PLANS FOR EACH PHASE OF CONSTRUCTION OR AS DIRECTED BY THE ENGINEER. THE SILT FENCE, SHALL REMAIN IN PLACE UNTIL THE CONSTRUCTION IS COMPLETED OR AS DIRECTED BY THE ENGINEER. TEMPORARY SODDING, PERMANENT SODDING, ETC SHALL BE PLACED IN DISTURBED SOILS. ALL DISCHARGE FROM DEWATERING PUMPS WILL BE DIRECTED TO THE INTERCHANGE INFIELD AREAS. REFER TO SWPPP PAGE 8 FOR ADDITIONAL INFORMATION.

### a. EROSION AND SEDIMENT CONTROLS:

#### (1) STABILIZATION PRACTICES:

- \_\_\_ TEMPORARY SODDING
- \_\_\_ TEMPORARY GRASSING
- \_\_\_ PERMANENT PLANTING, SODDING, OR SEEDING
- \_\_\_ TEMPORARY MULCHING
- \_\_\_ ARTIFICIAL COVERING
- \_\_\_ BUFFER ZONES
- \_\_\_ PRESERVATION OF NATURAL RESOURCES
- \_\_\_ OTHER : THE CONTRACTOR IS TO MAINTAIN THE EXISTING VEGETATION WHEREVER POSSIBLE AND PERFORM DAILY DUST CONTROL.

#### (1) STRUCTURAL PRACTICES:

- X SAND BAGGING
- \_\_\_ SILT FENCES
- \_\_\_ WIND SCREEN
- \_\_\_ SYNTHETIC BALES
- \_\_\_ BERMS
- \_\_\_ DIVERSION, INTERCEPTOR, OR PERIMETER DITCHES
- \_\_\_ PIPE SLOPE DRAINS
- \_\_\_ FLUMES
- \_\_\_ ROCK BEDDING AT CONSTRUCTION EXIT
- \_\_\_ TIMBER BEDDING AT CONSTRUCTION EXIT
- \_\_\_ DITCH LINER
- \_\_\_ SEDIMENT TRAPS
- \_\_\_ SEDIMENT BASINS
- \_\_\_ STORM INLET SEDIMENT TRAP
- \_\_\_ STONE OUTLET STRUCTURES
- \_\_\_ CURBS AND GUTTERS
- \_\_\_ STORM SEWERS
- \_\_\_ VELOCITY CONTROL DEVICES
- \_\_\_ TURBIDITY BARRIER
- \_\_\_ RIP RAP
- \_\_\_ OTHER :

### b. DESCRIPTION OF STORM WATER MANAGEMENT:

N/A

### c. OTHER CONTROLS

#### (1) WASTE DISPOSAL:

ANY CONSTRUCTION DEBRIS GENERATED AS A RESULT OF THIS PROJECT WILL BE DISPOSED OF OFF-SITE AT AN APPROPRIATE WASTE DISPOSAL FACILITY

- a.) CONCRETE WASH OUT LOCATIONS WILL BE PROVIDED IN AREAS WHERE THE DISPOSAL MATERIALS WILL BE CONTAINED SO AS TO PREVENT DISCHARGE OUTSIDE OF THE PROJECT LIMITS AND INTO THE WATERWAYS.
- b.) NEW DRAINAGE STRUCTURES WILL BE PROTECTED WITH SYNTHETIC BALES AND/OR FILTER FABRIC.
- c.) STAGING AREAS WILL BE LOCATED WITHIN THE PROJECT WORK ZONE UNLESS REQUESTED OTHERWISE FOR APPROVAL.
- d.) LITTER WILL BE DEPOSITED IN APPROPRIATE LOCATIONS. A DUMPSTER MAY BE PROVIDED AT THE SITE DEPENDING ON THE AMOUNT OF LITTER GENERATED.
- e.) LOADED TRUCKS WILL BE COVERED WITH TARP.
- f.) SWEEPERS AND/OR WATER TRUCKS WILL BE PROVIDED TO REDUCE DUST DAILY.
- g.) SOIL PREVENTION TRACKING WILL BE INSTALLED AS PER THE SWPPP AND/OR AS DIRECTED BY CITY INSPECTOR.

#### (2) OFFSITE VEHICLE TRACKING:

- \_\_\_ HAUL ROADS DAMPENED FOR DUST CONTROL
- \_\_\_ LOADED HAUL TRUCKS TO BE COVERED WITH TARPULIN
- \_\_\_ EXCESS DIRT ON ROAD REMOVED DAILY
- \_\_\_ STABILIZED CONSTRUCTION ENTRANCE
- \_\_\_ WATER TRUCK SCHEDULING
- \_\_\_ STREET SWEEPING (DAILY)
- \_\_\_ OTHER :

#### (3) SANITARY WASTE:

N/A

#### (4) FERTILIZERS, PESTICIDES AND TREES:

NO FERTILIZERS OR PESTICIDES WILL BE USED AT THE SITE. PROTECT ALL TREES WITHIN PROJECT LIMITS AS PER FDOT INDEX No. 544.

#### (5) TOXIC SUBSTANCES:

TOXIC SUBSTANCES WILL NOT BE STORED AT THE SITE.

#### (6) NON-STORM WATER DISCHARGE (INCLUDING SPILL REPORTING):

(7) NO NON-STORMWATER DISCHARGES ARE ANTICIPATED AT THIS TIME. CONTAMINATED SOIL OR GROUNDWATER ENCOUNTERED SHALL BE REPORTED IMMEDIATELY TO THE CITY PERSONNEL IN ACCORDANCE WITH PW BULLETIN No. 25. IF DEWATERING IS IMPLEMENTED, THE WATER WILL BE DEPOSITED IN A CONTROLLED AREA ON-SITE TO PREVENT OFF-SITE DISCHARGE OR AS APPROVED BY PERMIT.

### (7) EROSION CONTROL DEVICES

LOCATIONS AND TYPES OF ALL EROSION CONTROL DEVICES SHALL BE INSTALLED AS DIRECTED BY PLAN AND/OR BY THE CITY OF MIAMI. CONTRACTOR SHALL IMPLEMENT THE SWPPP AS PER THE CONTRACT PLANS AND MAY BE REVISED BASED ON ACTUAL FIELD CONDITIONS AT THE TIME WORK IS BEING PERFORMED. FIELD MODIFICATIONS WILL BE APPROVED BY THE CITY OF MIAMI.

MONITORING SHALL BE PERFORMED ON A WEEKLY BASIS AND AFTER A 1/2" STORM EVENT WITH ROUTINE MAINTENANCE AND REPLACEMENT OF ANY DEVICES AS REQUIRED.

CONTAINMENT OR REMOVAL OF POLLUTANTS SHALL BE IN ACCORDANCE WITH ALL APPLICABLE STATE AND CITY OF MIAMI REGULATIONS AND/OR FDOT STANDARD SPECIFICATIONS.

THE RESPONSIBLE PERSONS FOR MONITORING AND MAINTAINING THE EROSION CONTROL DEVICES SHALL BE:

CONTRACTOR:

TELEPHONE:

### REMARKS:

IF CONTAMINATED SOIL OR GROUNDWATER IS ENCOUNTERED, CONTACT CONSTRUCTION MANAGER AT 305-416-1281

### d. APPROVED STATE, LOCAL PLANS, OR STORM WATER PERMITS: (CHECK ALL THAT APPLY)

1. NPDES PERMIT (0.5 ACRE OR MORE)

2. NATIONAL POLLUTION DISCHARGE ELIMINATION SYSTEM (NPDES) PERMIT FROM THE FLORIDA DEPARTMENT OF ENVIRONMENTAL PROTECTION (FDEP) FOR PROJECTS DISTURBING MORE THAN 1 ACRE.

3. DADE COUNTY DEPARTMENT ON ENVIRONMENTAL RESOURCE MANAGEMENT (DERM) CLASS II-STORMWATER MANAGEMENT PERMIT AND DEWATERING PERMIT.

4. ENVIRONMENTAL RESOURCES (ERP) PERMIT FROM THE SOUTH FLORIDA WATER MANAGEMENT DISTRICT (SFWMD)

5. U.S. ARMY CORP OF ENGINEERS DREDGE AND FILL PERMIT.

6. SOUTH FLORIDA WATER MANAGEMENT DISTRICT (SFWMD) RIGHT-OF-WAY USE PERMIT.

7. PUBLIC WORKS EXCAVATION PERMIT

8. POLICE

9. TREE PERMIT

10. CITY DEWATERING PERMIT

### 3. MAINTENANCE:

● ALL MEASURES WILL BE MAINTAINED IN GOOD WORKING ORDER; IF A REPAIR IS NECESSARY, IT WILL BE INITIATED WITHIN 24 HOURS OF REPORT.

● BUILT UP SEDIMENT WILL BE REMOVED FROM SILT FENCE WHEN IT HAS REACHED ONE-THIRD OF THE HEIGHT OF THE FENCE.

● PROTECT ALL INLETS SURROUNDING CONSTRUCTION SITE.

● STREET SWEEPING AND DUST PREVENTION MUST BE IMPLEMENTED DAILY.

### 4. INSPECTION:

a. QUALIFIED PERSONNEL FROM THE CITY AND CONTRACTOR

SHALL INSPECT THE FOLLOWING ITEMS DAILY THROUGHOUT THE CONSTRUCTION PERIOD.

b. PREPARATION OF THE CONTRACTOR'S WEEKLY REPORT OF INSPECTION, MAINTENANCE AND REPAIRS FOR THE CONTROL AND ABATEMENT OF EROSION AND WATER POLLUTION SHALL BE INCLUDED IN THE COST OF THE RESPECTIVE PAY ITEMS. WHERE SITES HAVE BEEN FINALLY STABILIZED, INSPECTIONS SHALL BE CONDUCTED WEEKLY.

● POINTS OF DISCHARGE TO WATERS OF THE UNITED STATES

● POINTS OF DISCHARGE TO MUNICIPAL SEPARATE STORM SEWER SYSTEMS

● DISTURBED AREAS OF THE SITE THAT HAVE NOT BEEN FINALLY STABILIZED

● AREAS USED FOR STORAGE OF MATERIALS THAT ARE EXPOSED TO PRECIPITATION

● STRUCTURAL CONTROLS

● STORMWATER MANAGEMENT SYSTEMS

● LOCATIONS WHERE VEHICLES ENTER OR EXIT THE SITE

● STREET SWEEPING AND DUST CONTROL

c. A MAINTENANCE INSPECTION REPORT WILL BE MADE AFTER EACH INSPECTION. IF REPAIR IS NECESSARY, IT WILL BE INITIATED WITHIN 24 HOURS OF THE REPORT

d. REMOVE EXCESS DIRT FROM ALL ROADS ADJACENT TO PROJECT AREA ON A DAILY BASIS.

e. SEDIMENT FOUND IN DRAINAGE INSPECTION WILL REQUIRE DRAINAGE SYSTEM CLEANING BY CONTRACTOR.

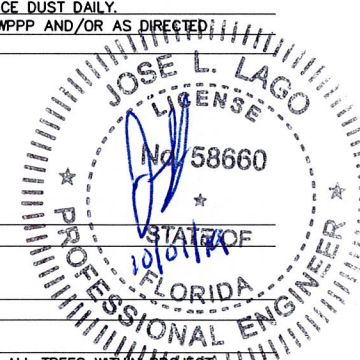

REVISIONS		
DATE	BY	DESCRIPTION

JOSE L. LAGO, P.E., CFM  
 CITY OF MIAMI - PM  
 P.E. No. 58660

CITY OF MIAMI OFFICE OF CAPITAL IMPROVEMENTS	
PROJECT NAME	PROJECT No.
THE ROADS NEIGHBORHOOD TRAFFIC CALMING	B- 193619



**NOTES FOR SYNTHETIC BALES OR BALE TYPE BARRIERS**

1. TYPE I AND II SYNTHETIC BARRIER SHOULD BE SPACED IN ACCORDANCE WITH CHART 1, SHEET 1 PER INDEX 102.
2. BALES SHALL BE ANCHORED WITH 2-1" X 2" (OR 1" DIA.) X 4' WOOD STAKES. STAKES OF OTHER MATERIAL OR SHAPE PROVIDING EQUIVALENT STRENGTH MAY BE USED IF APPROVED BY THE ENGINEER. STAKES OTHER THAN WOOD SHALL BE REMOVED UPON COMPLETION OF THE PROJECT.
3. RAILS AND POSTS SHALL BE 2" X 4" WOOD. OTHER MATERIALS PROVIDING EQUIVALENT STRENGTH MAY BE USED IF APPROVED BY THE ENGINEER.
4. ADJACENT BALES SHALL BE BUTTED FIRMLY TOGETHER.
5. WHERE USED IN CONJUNCTION WITH SILT FENCE, BALES SHALL BE PLACED ON THE UPSTREAM SIDE OF THE FENCE.

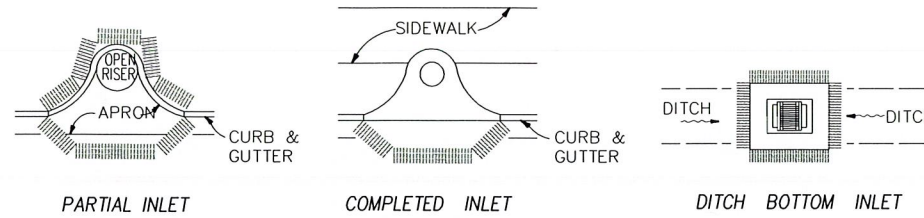

**PROTECTION AROUND INLETS OR SIMILAR STRUCTURES**

N.T.S.

**STORM WATER POLLUTION PREVENTION PRACTICES:  
(FOR PROJECT OF 0.5 ACRE OR MORE --CITY ORDINANCE No. 13081)**

1. TREE PROTECTION AND PRUNING SHALL BE ACCOMPLISHED AS DETAILED IN SPECIAL PROVISIONS, THE CONSTRUCTION PLANS, AND OR PER TREE ORDINANCE 12636.
  2. THE STORM WATER POLLUTION PREVENTION PLAN, SWPPP, SUBMITTED TO PUBLIC WORKS, SHALL DESCRIBE IN DETAIL HOW THE CONSTRUCTION EFFORT WILL BE PHASED WITH REGARDS TO MINIMIZING EROSION PROBLEMS BY THE USE OF TEMPORARY AND PERMANENT EROSION CONTROL MEASURES, FOR THE VARIOUS SEQUENCES OF CONSTRUCTION OPERATIONS. ANY MODIFICATIONS MUST BE APPROVED BY THE CITY OF MIAMI - NPDES SECTION, DEPARTMENT OF PUBLIC WORKS.
  3. ENVIRONMENTAL CONTROL FEATURES AS PROVIDED IN THE SWPPP, ARE TO BE INSTALLED AT ALL AREAS OF EXCAVATION OR FILL FOR DRAINAGE SYSTEM, OR STRUCTURE CONSTRUCTION PRIOR TO SUCH EXCAVATION OR FILL. INLET ENTRANCES ARE ALSO TO BE PROTECTED FROM SILTATION AS DETAILED ON SHEET 2 OF 4 OF MISC. 35-89-6.
  4. ALL ENVIRONMENTAL CONTROL FEATURES ARE TO BE MAINTAINED THROUGHOUT THE LIFE OF THE PROJECT IN ACCORDANCE WITH N.P.D.E.S. REQUIREMENTS. THE CONTRACTOR MUST INSURE THAT ALL EROSION CONTROL FEATURES FUNCTION PROPERLY AT ALL TIMES.
  5. ALL EROSION AND MATERIAL DEPOSITS MUST BE CONTAINED WITHIN THE PROJECT LIMITS.
  6. ANY DAMAGED OR INEFFECTIVE ROCK BAGS ARE TO BE REPLACED WITH NEW ONES. THE LOCATION OF ROCK BAGS INSTALLATION IS AS MENTIONED IN THE SWPPP PLANS. THE PROJECT ENGINEER MAY SPECIFY OTHER AREAS AS NECESSARY.
  7. DITCH BOTTOM INLETS SHALL BE PROTECTED FROM SEDIMENT INTAKE UNTIL PROJECT IS COMPLETE. ELEVATION OF GROUND OUTSIDE INLET TOP SHALL NOT BE HIGHER THAN INLET TOP. ROCK BAGS SHALL BE INSTALLED AROUND INLET TOP. COMPLETED INLETS IN PAVED AREAS SHALL ALSO BE PROTECTED WITH ROCK BAGS TO PREVENT SEDIMENT INTAKE.
  8. CURB INLETS ALSO SHALL BE PROTECTED FROM SEDIMENT INTAKE UNTIL THE PROJECT IS COMPLETE. ALL EXPOSED SLOPED MATERIAL ADJACENT TO INLET, SHALL BE COVERED WITH EROSION CONTROL MATTING WITH OUTER LIMITS PROTECTED BY ROCK BAGS.
  9. STOCKPILED MATERIAL SHALL NOT BE LEFT IN EROSION PRONE AREAS UNLESS PROTECTED BY COVER OR ROCK BAGS.
  10. INSPECTION OF EROSION CONTROL MEASURES AND CONDITION OF ADJACENT PROPERTIES, SHALL BE PERFORMED DAILY BY THE CONTRACTOR'S REPRESENTATIVE AND THE PROJECT ENGINEER. DEFICIENCIES SHALL BE NOTED AND CORRECTED.
  11. ANY OFFSITE SEDIMENT DISCHARGE TO A MUNICIPAL SEPARATE STORM WATER SYSTEM ARISING FROM THE CONTRACTOR'S ACTIVITIES IS NOT ALLOWED. REFER TO PUBLIC WORKS DEPARTMENT BULLETIN NO. 25 AND CITY ORDINANCE 13081.
  12. THE USE OF SANITARY SEWERS, FRENCH DRAINS, COVER DITCHES AND/OR ROCK DRAINS FOR THE DISPOSAL OF WASTEWATER IS EXPRESSLY PROHIBITED. REFER TO PUBLIC WORKS DEPARTMENT BULLETIN NO. 25 AND CITY ORDINANCE 13081.
- \* NPDES - NATIONAL POLLUTION DISCHARGE ELIMINATION SYSTEM AUTHORIZED BY NPDES PERMIT FLS 000002. BMP - BEST MANAGEMENT PRACTICE.

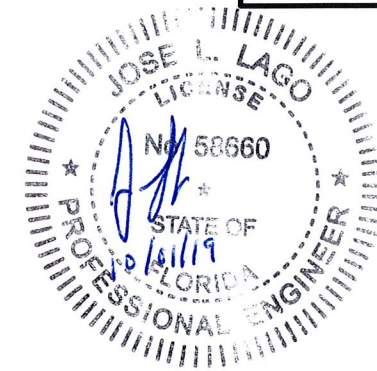

**STORM WATER POLLUTION PREVENTION PLAN (SWPPP) CHECKLIST**

**A. SEQUENCE OF SOIL DISTURBING ACTIVITIES AND IMPLEMENTATION OF CONTROLS:**

1. CLEAR & GRUBBING
2. INSTALL DRAINAGE STRUCTURES
3. STABILIZATION
4. BASE PREPARATION
5. ASPHALT APPLICATION
6. PLACEMENT OF ROCK BAGS AROUND INLETS
7. PLACEMENT OF ROCK BAGS AROUND MANHOLES
8. APPLICATION OF FRICTION COURSE A.C.
9. INSTALLATION OF STREET SIGNING
10. PAVEMENT MARKING
11. REMOVE ROCK BAGS
12. CLEAN ALL CONSTRUCTION DEBRIS FROM CONSTRUCTION SITE

**B. GENERAL**

1. APPROVED STATE, LOCAL PLANS OR STORM WATER PERMITS.
2. ALL OF THE CONTROLS SHALL BE MAINTAINED AT ALL TIMES.
3. ALL CONTROLS SHALL BE INSPECTED DAILY.
4. APPLY FERTILIZERS AND PESTICIDES ACCORDING TO STANDARD SPECIFICATIONS, DESIGN AND SPECIAL PROVISIONS.
5. REPORT NON-STORM WATER DISCHARGE (INCLUDING SPILL) (305) 416-1200.
6. VISIT [WWW.DEP.STATE.FL.US/WATER/STORMWATER/NPDES/](http://WWW.DEP.STATE.FL.US/WATER/STORMWATER/NPDES/)

**NOTES:**

TOTAL ACREAGE OF DISTURBED SOIL : LESS THAN 0.5 ACRE  
 PW NPDES PERMIT NO. \_\_\_\_\_  
 DATE ISSUED: \_\_\_\_\_

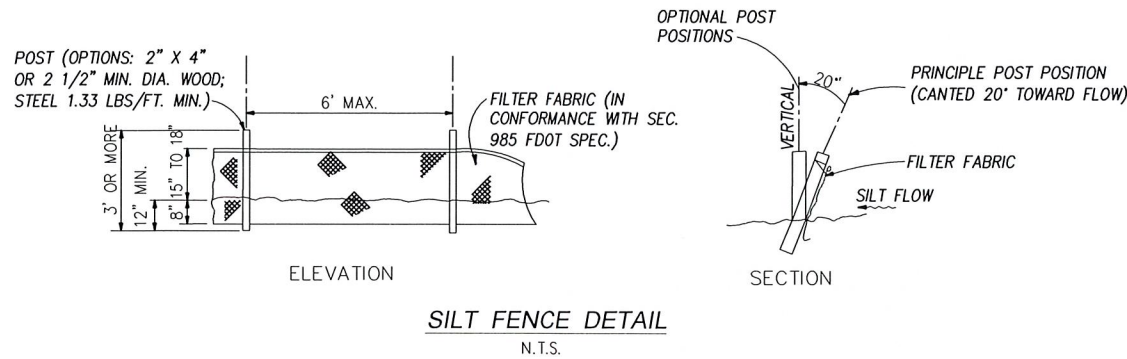

**SILT FENCE DETAIL**

N.T.S.

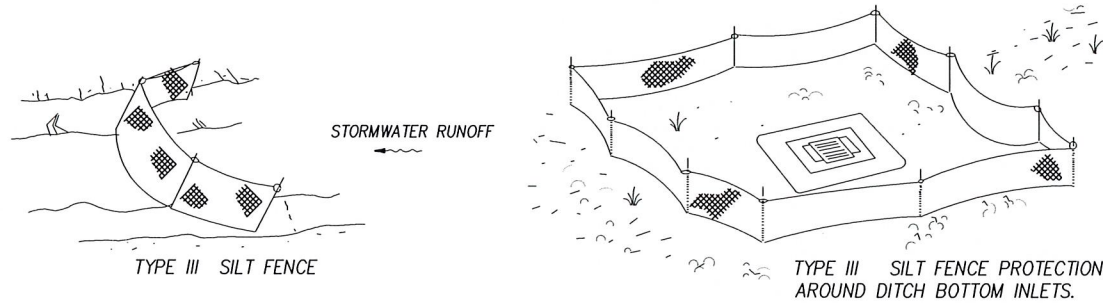

**NOTES:**

1. SPACING FOR TYPE III FENCE TO BE IN ACCORDANCE WITH CHART I, SHEET 1 OF 3 AND DITCH INSTALLATIONS AT DRAINAGE STRUCTURES SHEET 2 OF 3 PER FOOT STANDARD INDEX 102.
2. DO NOT DEPLOY IN A MANNER THAT SILT FENCES WILL ACT AS A DAM ACROSS PERMANENT FLOWING WATERCOURSES. SILT FENCES ARE TO BE USED AT UPLAND LOCATIONS AND TURBIDITY BARRIERS USED AT PERMANENT BODIES OF WATER.

**SILT FENCE APPLICATIONS**

N.T.S.

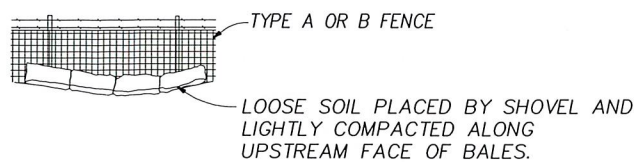

**BALES BACKED BY FENCE**

N.T.S.

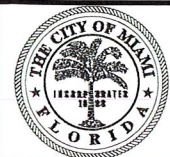

**CITY OF MIAMI**  
 OFFICE OF CAPITAL IMPROVEMENTS  
 444 S.W. 2ND AVENUE, 8TH FLOOR  
 MIAMI, FLORIDA 33130  
 (305) 416-1280 - FAX (305) 416-1253

REVISIONS		
DATE	BY	DESCRIPTION

JOSE L. LAGO, P.E., CFM  
 CITY OF MIAMI - PM  
 P.E. No. 58660

**CITY OF MIAMI**  
 OFFICE OF CAPITAL IMPROVEMENTS  
 PROJECT NAME: THE ROADS NEIGHBORHOOD TRAFFIC CALMING  
 PROJECT No.: B- 193619

**SWPPP NOTES AND DETAILS**

SHEET NO.  
**9**